

## EKVM 30/32 VG B 30-16

Cable gland similar to VG 88773, brass, earthing insert acc. tor VG 88812 M30-32

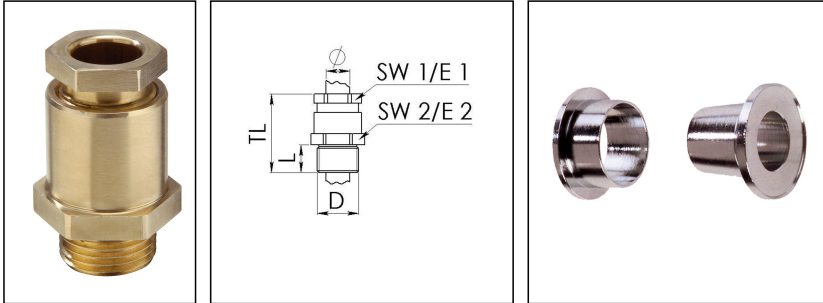

Products may differ in size, colour and appearance to those shown. If you require further information or customisation, please contact us directly.



<b>Material cable gland</b>	Brass
<b>Material earthing insert</b>	Brass plated
<b>Temp. range min</b>	-30 °C
<b>Temp. range max</b>	80 °C
<b>Protection class</b>	IP30
<b>Thread type</b>	M
<b>Ø Connection thread D</b>	32
<b>Lead</b>	1,5
<b>Length screw-in thread L</b>	12 mm
<b>Ø cable diameter max</b>	20,5 mm
<b>Ø cable below cable shield max</b>	-16 mm
<b>Key width SW1</b>	30 mm
<b>Key width SW2</b>	36 mm
<b>Collar diameter E1</b>	33 mm
<b>Collar diameter E2</b>	39 mm
<b>Total length TL</b>	51 mm
<b>Surface</b>	Bright
<b>Order no. bright</b>	10016513
<b>Type</b>	EKVM 30/32 VG B 30-16
<b>Packing unit</b>	1
<b>Tariff number</b>	85369010
<b>EAN number</b>	4007685165136

23.05.2026

Your Contact:

**WISKA Hoppmann GmbH**

Kisdorfer Weg 28 · 24568 Kaltenkirchen · Germany

☎ +49-4191-508-0 · 📠 +49-4191-508-209

contact@wiska.de · www.wiska.com

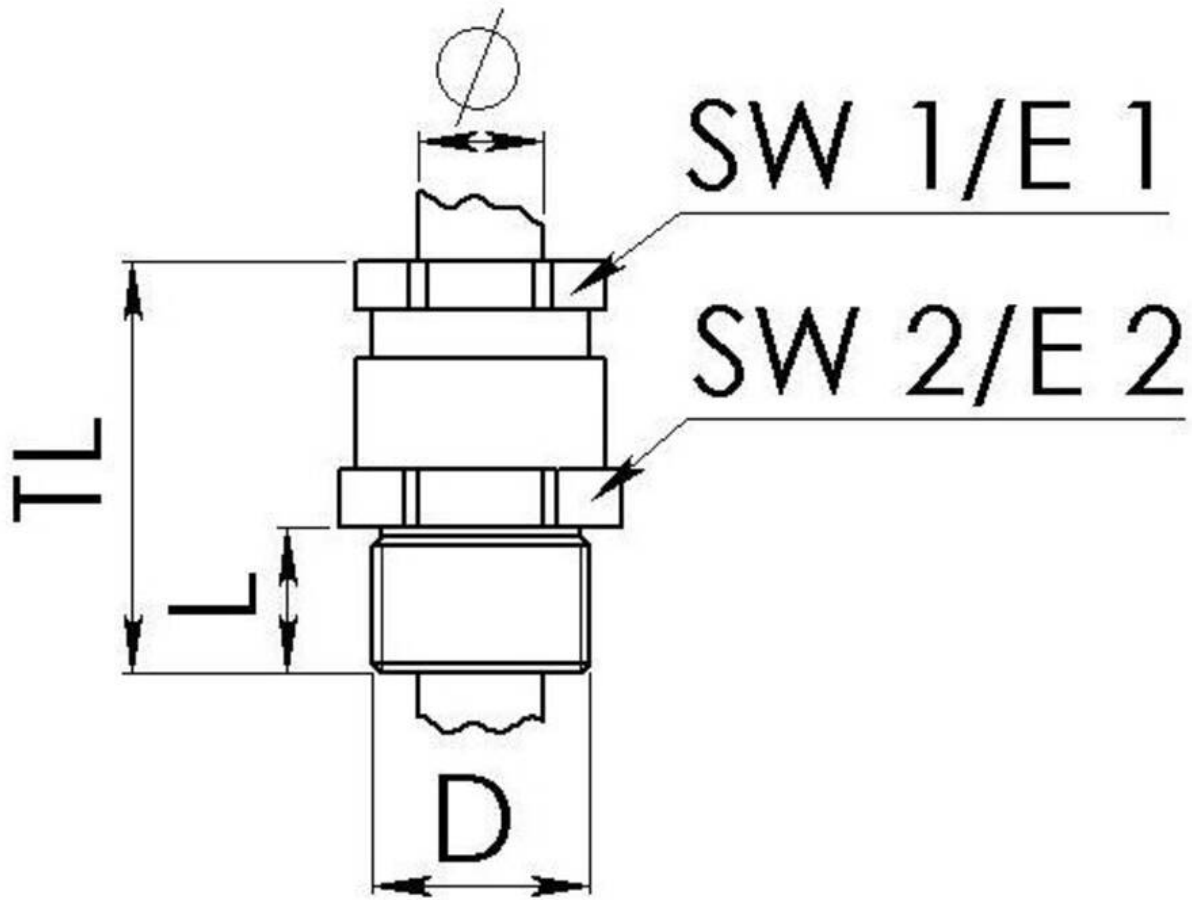

Your Contact:  
**WISKA Hoppmann GmbH**  
Kisdorfer Weg 28 · 24568 Kaltenkirchen · Germany  
☎ +49-4191-508-0 · 📠 +49-4191-508-209  
contact@wiska.de · www.wiska.com