

KVMS 36-W26/Ni

Cable gland, brass nickel-plated, DIN 89280, M36

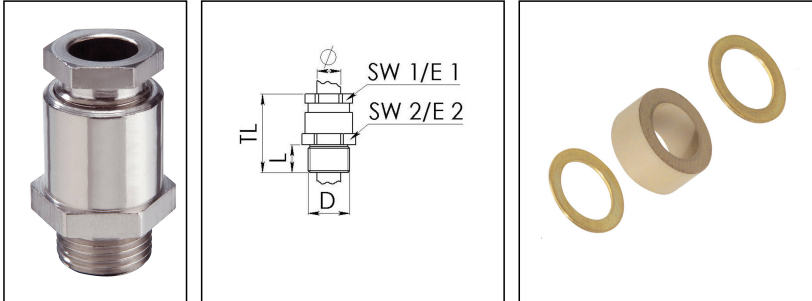

Products may differ in size, colour and appearance to those shown. If you require further information or customisation, please contact us directly.



Material cable gland	Brass nickel-plated
Material sealing gasket	EPDM
Temp. range min	-40 °C
Temp. range max	100 °C
Protection class	IP54
Thread type	M
Ø Connection thread D	36
Lead	2
Length screw-in thread L	13 mm
Ø cable diameter min	24 mm
Ø cable diameter max	26,5 mm
Key width SW1	36 mm
Key width SW2	41 mm
Collar diameter E1	39 mm
Collar diameter E2	45 mm
Total length TL	58 mm
Install. torques fitting	15 N m
Install. torques cap nut	15 N m
Surface	Nickel-plated
Order no. nickel-plated	10016710
Type	KVMS 36-W26/Ni
Packing unit	1
Tariff number	85369010
EAN number	4007685167109
ETIM-Classification	EC000441

Your Contact:

WISKA Hoppmann GmbH

Kisdorfer Weg 28 · 24568 Kaltenkirchen · Germany

☎ +49-4191-508-0 · 📠 +49-4191-508-209

contact@wiska.de · www.wiska.com

Recommended accessories

GM 36/Ni

10012815

23.05.2026

Your Contact:

WISKA Hoppmann GmbH

Kisdorfer Weg 28 · 24568 Kaltenkirchen · Germany

 +49-4191-508-0 ·  +49-4191-508-209

contact@wiska.de · www.wiska.com

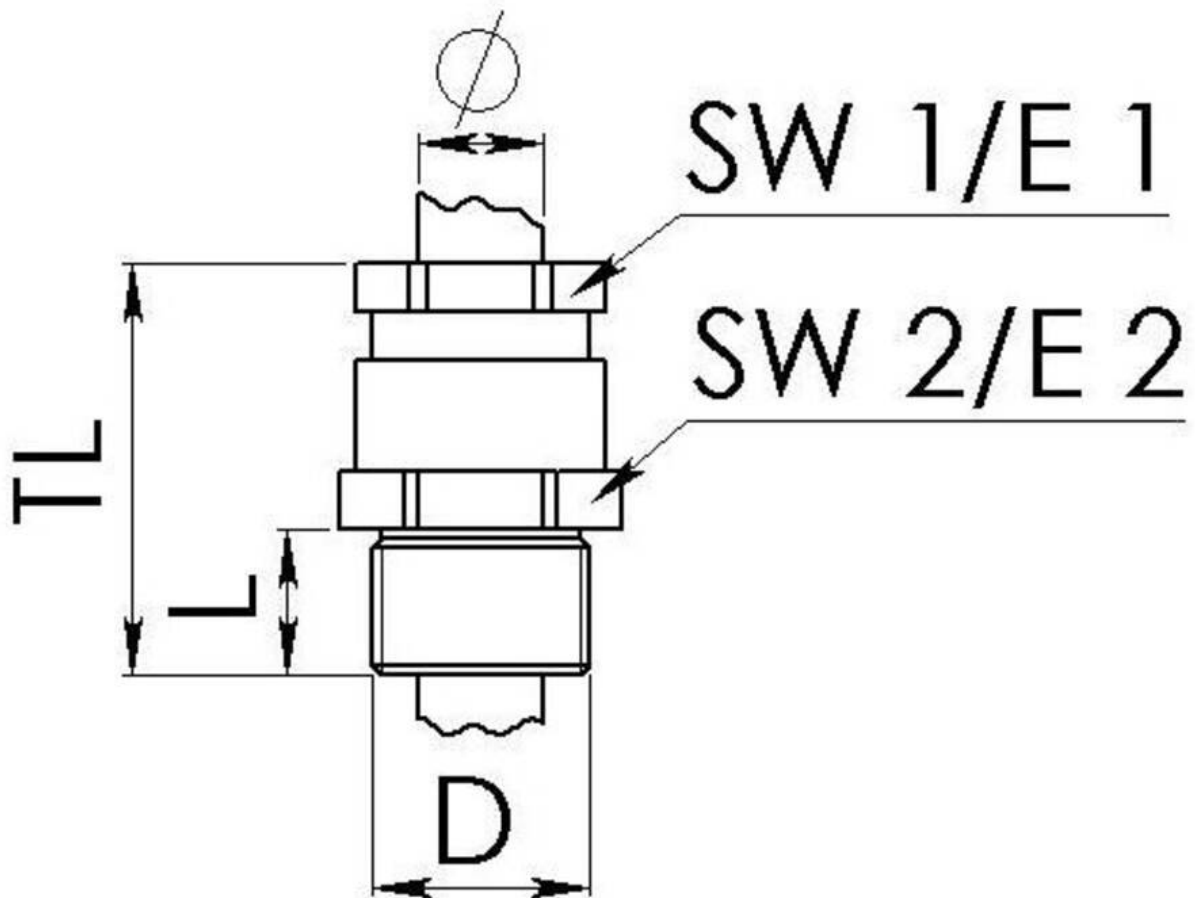

Your Contact:

WISKA Hoppmann GmbH

Kisdorfer Weg 28 · 24568 Kaltenkirchen · Germany

☎ +49-4191-508-0 · 📠 +49-4191-508-209

contact@wiska.de · www.wiska.com