

EKVM 36/40-W22/Cr

Cable gland, brass chromed-plated, DIN 89280, M36-M40



Products may differ in size, colour and appearance to those shown. If you require further information or customisation, please contact us directly.



Material cable gland	Brass chromium-plated
Material sealing gasket	EPDM
Temp. range min	-40 °C
Temp. range max	100 °C
Protection class	IP54
Thread type	M
Ø Connection thread D	40
Lead	1,5
Length screw-in thread L	13 mm
Ø cable diameter min	20 mm
Ø cable diameter max	22,5 mm
Key width SW1	36 mm
Key width SW2	46 mm
Collar diameter E1	39 mm
Collar diameter E2	50 mm
Total length TL	56 mm
Install. torques fitting	15 N m
Install. torques cap nut	15 N m
Surface	Chromium-plated
Order no. chrome-plated	10016760
Type	EKVM 36/40-W22/Cr
Packing unit	1
Tariff number	85369010
EAN number	4007685167604
ETIM-Classification	EC000441

Your Contact:

WISKA Hoppmann GmbH

Kisdorfer Weg 28 · 24568 Kaltenkirchen · Germany

☎ +49-4191-508-0 · 📠 +49-4191-508-209

contact@wiska.de · www.wiska.com

23.05.2026

Your Contact:
WISKA Hoppmann GmbH
Kisdorfer Weg 28 · 24568 Kaltenkirchen · Germany
☎ +49-4191-508-0 · 📠 +49-4191-508-209
contact@wiska.de · www.wiska.com

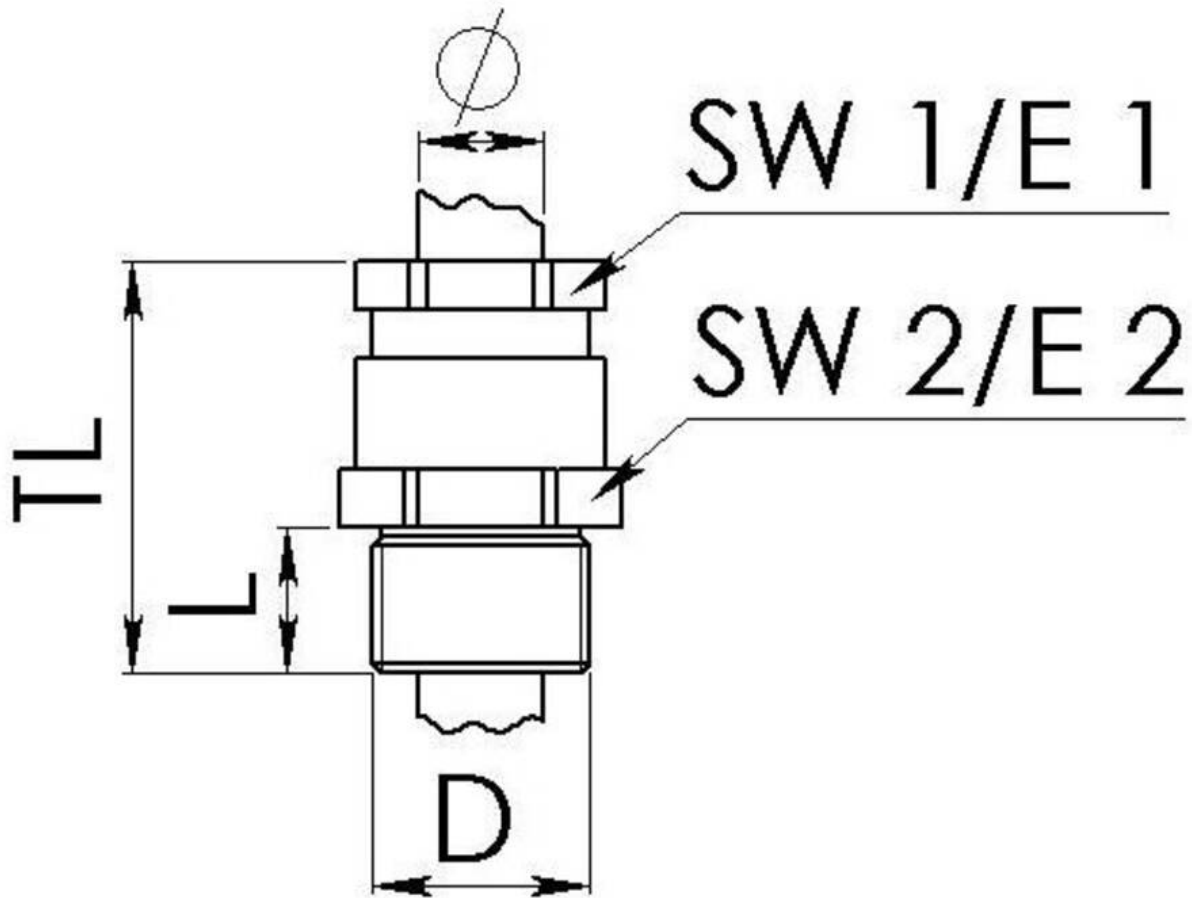

Your Contact:

WISKA Hoppmann GmbH

Kisdorfer Weg 28 · 24568 Kaltenkirchen · Germany

☎ +49-4191-508-0 · 📠 +49-4191-508-209

contact@wiska.de · www.wiska.com