

EKVM 45/50-W30/Cr

Cable gland, brass chromed-plated, DIN 89280, M45-M50



Products may differ in size, colour and appearance to those shown. If you require further information or customisation, please contact us directly.



Material cable gland	Brass chromium-plated
Material sealing gasket	EPDM
Temp. range min	-40 °C
Temp. range max	100 °C
Protection class	IP54
Thread type	M
Ø Connection thread D	50
Lead	1,5
Length screw-in thread L	14 mm
Ø cable diameter min	28 mm
Ø cable diameter max	30,5 mm
Key width SW1	46 mm
Key width SW2	55 mm
Collar diameter E1	50 mm
Collar diameter E2	61 mm
Total length TL	59 mm
Install. torques fitting	20 N m
Install. torques cap nut	15 N m
Surface	Chromium-plated
Order no. chrome-plated	10016764
Type	EKVM 45/50-W30/Cr
Packing unit	1
Tariff number	85369010
EAN number	4007685167642
ETIM-Classification	EC000441

Your Contact:

WISKA Hoppmann GmbH

Kisdorfer Weg 28 · 24568 Kaltenkirchen · Germany

☎ +49-4191-508-0 · 📠 +49-4191-508-209

contact@wiska.de · www.wiska.com

23.05.2026

Your Contact:
WISKA Hoppmann GmbH
Kisdorfer Weg 28 · 24568 Kaltenkirchen · Germany
☎ +49-4191-508-0 · 📠 +49-4191-508-209
contact@wiska.de · www.wiska.com

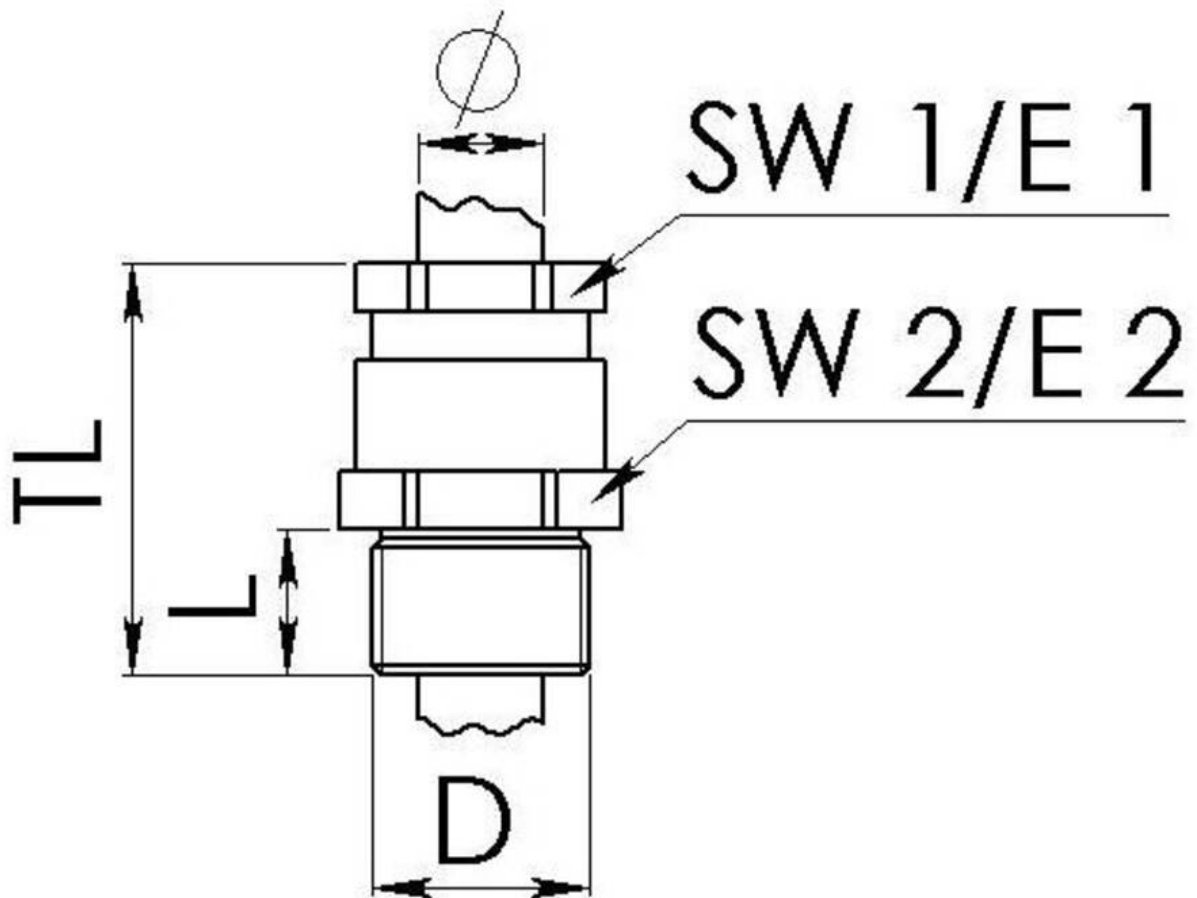

Your Contact:

WISKA Hoppmann GmbH

Kisdorfer Weg 28 · 24568 Kaltenkirchen · Germany

☎ +49-4191-508-0 · 📠 +49-4191-508-209

contact@wiska.de · www.wiska.com