

EKVM 56/63-W41/Cr

Cable gland, brass chromed-plated, DIN 89280, M56-M63



Products may differ in size, colour and appearance to those shown. If you require further information or customisation, please contact us directly.



Material cable gland	Brass chromium-plated
Material sealing gasket	EPDM
Temp. range min	-40 °C
Temp. range max	100 °C
Protection class	IP54
Thread type	M
Ø Connection thread D	63
Lead	1,5
Length screw-in thread L	15 mm
Ø cable diameter min	38 mm
Ø cable diameter max	41,5 mm
Key width SW1	55 mm
Key width SW2	68 mm
Collar diameter E1	61 mm
Collar diameter E2	75 mm
Total length TL	64 mm
Install. torques fitting	20 N m
Install. torques cap nut	15 N m
Surface	Chromium-plated
Order no. chrome-plated	10016768
Type	EKVM 56/63-W41/Cr
Packing unit	1
Tariff number	85369010
EAN number	4007685167680
ETIM-Classification	EC000441

Your Contact:

WISKA Hoppmann GmbH

Kisdorfer Weg 28 · 24568 Kaltenkirchen · Germany

☎ +49-4191-508-0 · 📠 +49-4191-508-209

contact@wiska.de · www.wiska.com

23.05.2026

Your Contact:
WISKA Hoppmann GmbH
Kisdorfer Weg 28 · 24568 Kaltenkirchen · Germany
☎ +49-4191-508-0 · 📠 +49-4191-508-209
contact@wiska.de · www.wiska.com

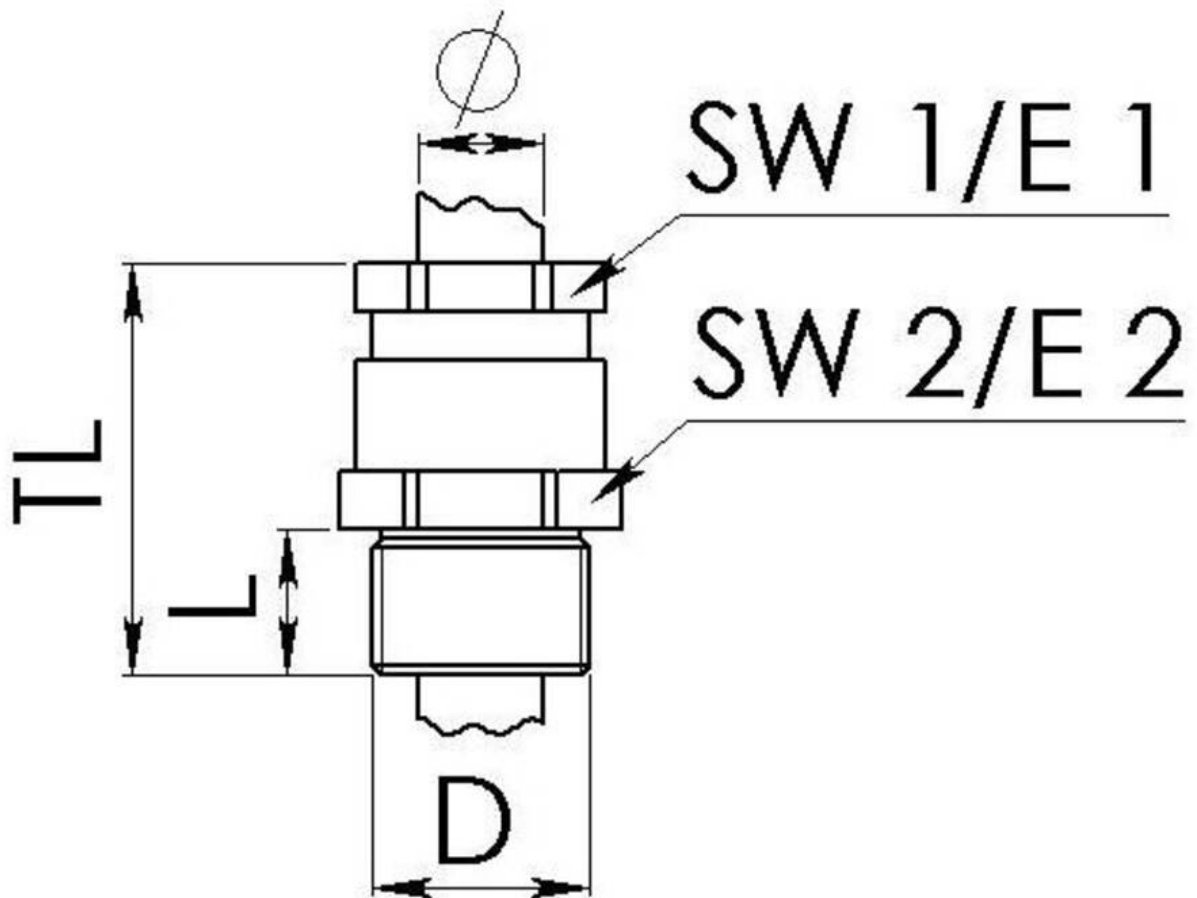

Your Contact:

WISKA Hoppmann GmbH

Kisdorfer Weg 28 · 24568 Kaltenkirchen · Germany

☎ +49-4191-508-0 · 📠 +49-4191-508-209

contact@wiska.de · www.wiska.com