

KVMS 72-W56/Cr

Cable gland, brass chromed-plated, DIN 89280, M72

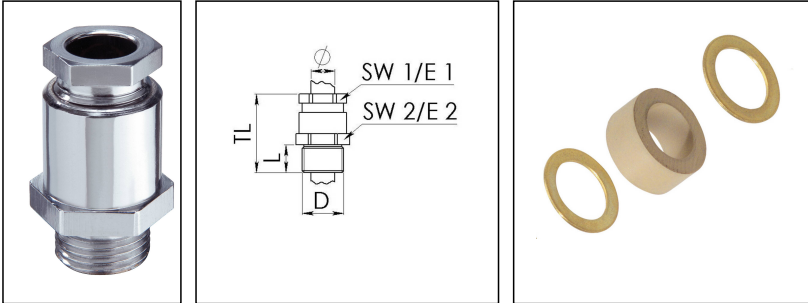

Products may differ in size, colour and appearance to those shown. If you require further information or customisation, please contact us directly.



| | |
|---------------------------------|-----------------------|
| Material cable gland | Brass chromium-plated |
| Material sealing gasket | EPDM |
| Temp. range min | -40 °C |
| Temp. range max | 100 °C |
| Protection class | IP54 |
| Thread type | M |
| Ø Connection thread D | 72 |
| Lead | 2 |
| Length screw-in thread L | 16 mm |
| Ø cable diameter min | 52 mm |
| Ø cable diameter max | 56,5 mm |
| Key width SW1 | 70 mm |
| Key width SW2 | 78 mm |
| Collar diameter E1 | 78 mm |
| Collar diameter E2 | 87 mm |
| Total length TL | 73 mm |
| Install. torques fitting | 20 N m |
| Install. torques cap nut | 15 N m |
| Surface | Chromium-plated |
| Order no. chrome-plated | 10016968 |
| Type | KVMS 72-W56/Cr |
| Packing unit | 1 |
| Tariff number | 85369010 |
| EAN number | 4007686097733 |
| ETIM-Classification | EC000441 |

Your Contact:

WISKA Hoppmann GmbH

Kisdorfer Weg 28 · 24568 Kaltenkirchen · Germany

☎ +49-4191-508-0 · 📠 +49-4191-508-209

contact@wiska.de · www.wiska.com

Recommended accessories

GM 72/Cr

10012075

23.05.2026

Your Contact:

WISKA Hoppmann GmbH

Kisdorfer Weg 28 · 24568 Kaltenkirchen · Germany

 +49-4191-508-0 ·  +49-4191-508-209

contact@wiska.de · www.wiska.com

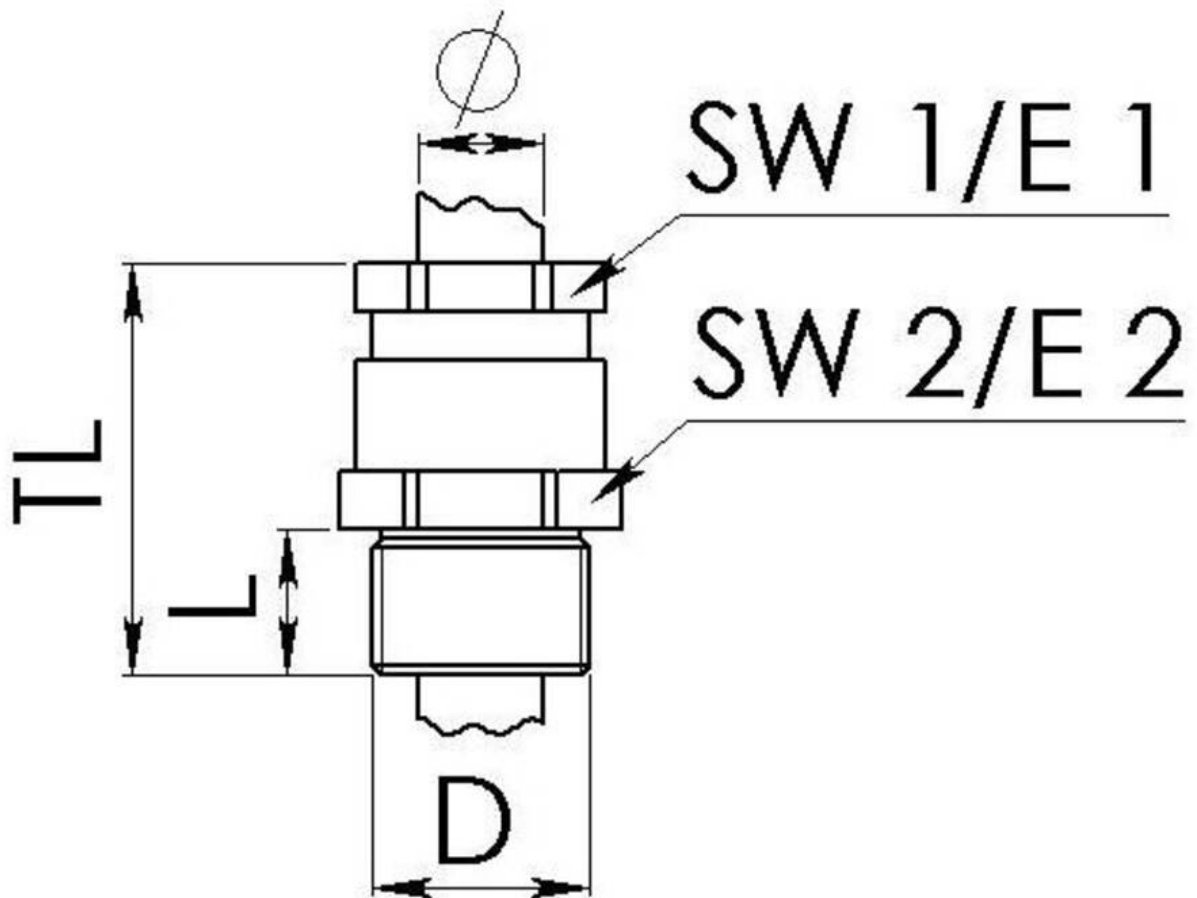

Your Contact:

WISKA Hoppmann GmbH

Kisdorfer Weg 28 · 24568 Kaltenkirchen · Germany

☎ +49-4191-508-0 · 📠 +49-4191-508-209

contact@wiska.de · www.wiska.com