

KVMS 105-W75/Cr

Cable gland, brass chromed-plated, similar to DIN 89280, M105



Products may differ in size, colour and appearance to those shown. If you require further information or customisation, please contact us directly.



Material cable gland	Brass chromium-plated
Material sealing gasket	EPDM
Temp. range min	-40 °C
Temp. range max	100 °C
Protection class	IP54
Thread type	M
Ø Connection thread D	105
Lead	2
Length screw-in thread L	20 mm
Ø cable diameter min	73 mm
Ø cable diameter max	78 mm
Key width SW1	105 mm
Key width SW2	115 mm
Collar diameter E1	114 mm
Collar diameter E2	127 mm
Total length TL	88 mm
Install. torques fitting	30 N m
Install. torques cap nut	30 N m
Advice	* Similar to DIN 89280
Surface	Chromium-plated
Order no. chrome-plated	10016971
Type	KVMS 105-W75/Cr
Packing unit	1
Tariff number	85369010
EAN number	4007686097795

Your Contact:

WISKA Hoppmann GmbH

Kisdorfer Weg 28 · 24568 Kaltenkirchen · Germany

☎ +49-4191-508-0 · 📠 +49-4191-508-209

contact@wiska.de · www.wiska.com

ETIM-Classification

EC000441

Recommended accessories

GM 105/Cr

10103708

23.05.2026

Your Contact:

WISKA Hoppmann GmbH

Kisdorfer Weg 28 · 24568 Kaltenkirchen · Germany

☎ +49-4191-508-0 · 📠 +49-4191-508-209

contact@wiska.de · www.wiska.com

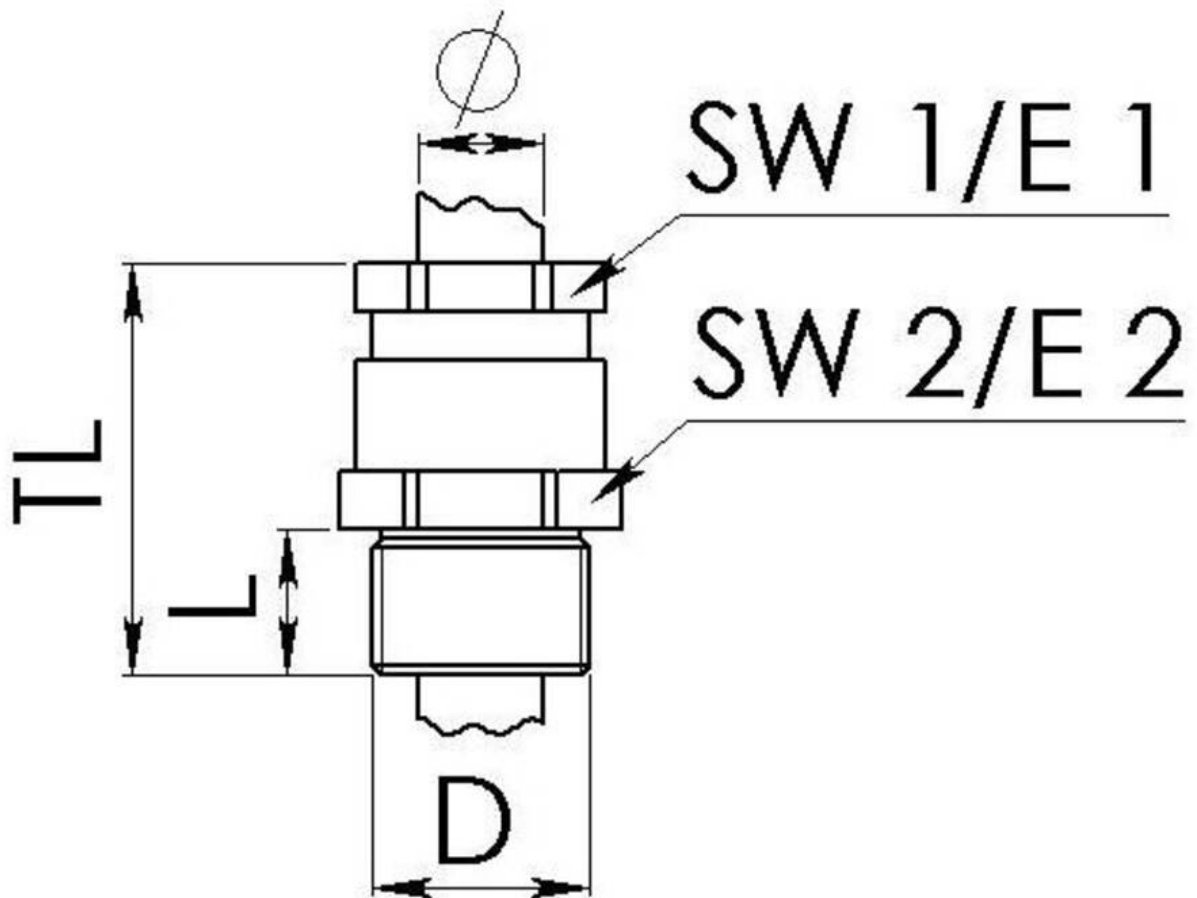

Your Contact:

WISKA Hoppmann GmbH

Kisdorfer Weg 28 · 24568 Kaltenkirchen · Germany

☎ +49-4191-508-0 · 📠 +49-4191-508-209

contact@wiska.de · www.wiska.com