

## KVMS 105-W80/Cr

Cable gland, brass chromed-plated, similar to DIN 89280, M105



Products may differ in size, colour and appearance to those shown. If you require further information or customisation, please contact us directly.



<b>Material cable gland</b>	Brass chromium-plated
<b>Material sealing gasket</b>	EPDM
<b>Temp. range min</b>	-40 °C
<b>Temp. range max</b>	100 °C
<b>Protection class</b>	IP54
<b>Thread type</b>	M
<b>Ø Connection thread D</b>	105
<b>Lead</b>	2
<b>Length screw-in thread L</b>	20 mm
<b>Ø cable diameter min</b>	78 mm
<b>Ø cable diameter max</b>	83 mm
<b>Key width SW1</b>	105 mm
<b>Key width SW2</b>	115 mm
<b>Collar diameter E1</b>	114 mm
<b>Collar diameter E2</b>	127 mm
<b>Total length TL</b>	88 mm
<b>Install. torques fitting</b>	30 N m
<b>Install. torques cap nut</b>	30 N m
<b>Advice</b>	* Similar to DIN 89280
<b>Surface</b>	Chromium-plated
<b>Order no. chrome-plated</b>	10016972
<b>Type</b>	KVMS 105-W80/Cr
<b>Packing unit</b>	1
<b>Tariff number</b>	85369010
<b>EAN number</b>	4007686097818

Your Contact:

WISKA Hoppmann GmbH

Kisdorfer Weg 28 · 24568 Kaltenkirchen · Germany

☎ +49-4191-508-0 · 📠 +49-4191-508-209

contact@wiska.de · www.wiska.com

**ETIM-Classification**

EC000441

**Recommended accessories**

**GM 105/Cr**

10103708

23.05.2026

Your Contact:

**WISKA Hoppmann GmbH**

Kisdorfer Weg 28 · 24568 Kaltenkirchen · Germany

 +49-4191-508-0 ·  +49-4191-508-209

contact@wiska.de · www.wiska.com

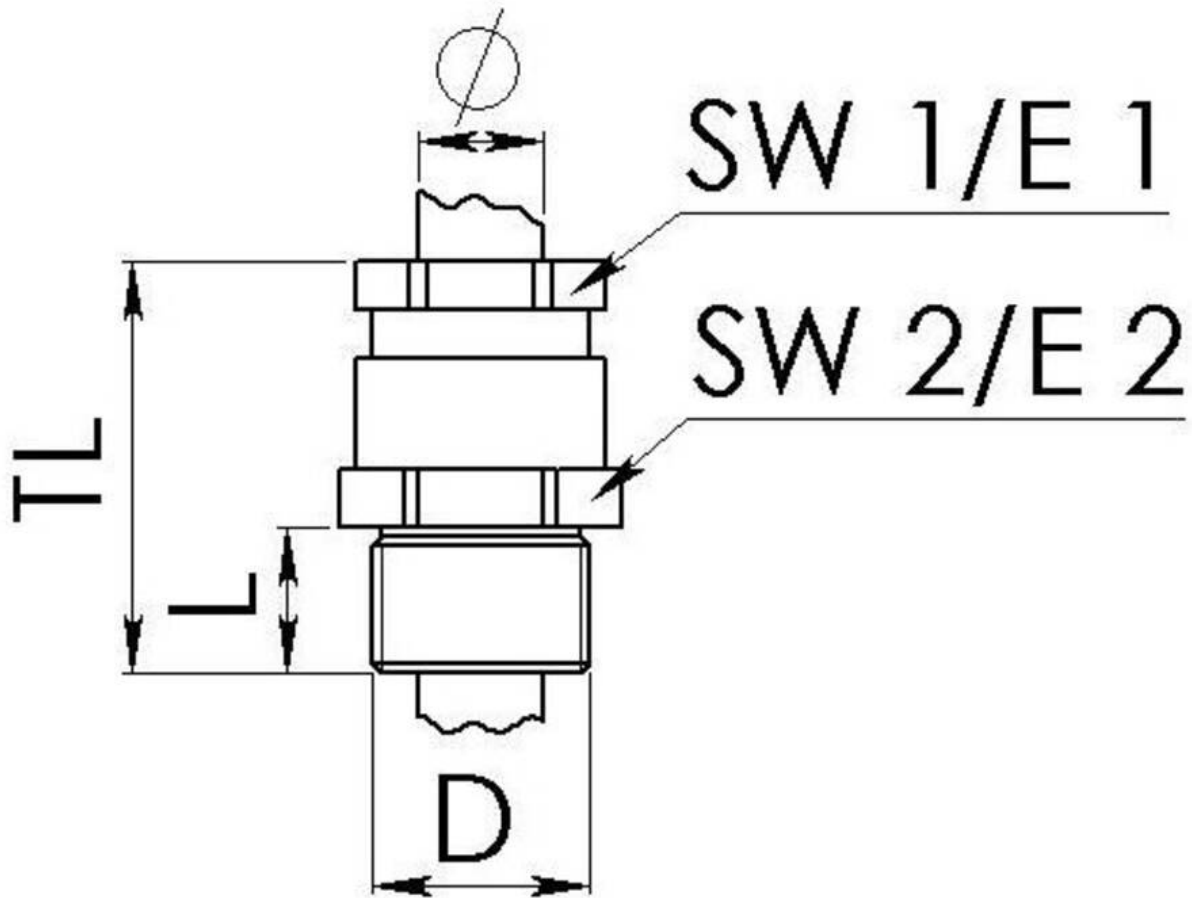

Your Contact:

**WISKA Hoppmann GmbH**

Kisdorfer Weg 28 · 24568 Kaltenkirchen · Germany

☎ +49-4191-508-0 · 📠 +49-4191-508-209

contact@wiska.de · www.wiska.com