

AMMP 20/11

Adaptor, brass nickel-plated, M20 / Pg11

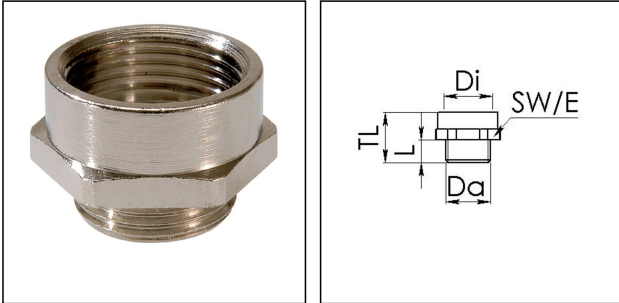

Products may differ in size, colour and appearance to those shown. If you require further information or customisation, please contact us directly.



Material	Brass nickel-plated
Temp. range min	-200 °C
Temp. range max	250 °C
Thread type outer	M
Ø outer thread	20
Lead outer	1,5
Length screw-in thread L	6 mm
Thread type inner	PG
Ø inner thread	11
Length internal thread	10 mm
Key width SW	22 mm
Collar diameter (E)	24 mm
Total length TL	17 mm
Form	A
Surface	Nickel-plated
Order no. nickel-plated	10063917
Type	AMMP 20/11
Packing unit	50
EAN number	4007685639170
Tariff number	74198090
ETIM-Classification	EC000938

Recommended accessories

Your Contact:

WISKA Hoppmann GmbH

Kisdorfer Weg 28 · 24568 Kaltenkirchen · Germany

☎ +49-4191-508-0 · 📠 +49-4191-508-209

contact@wiska.de · www.wiska.com

EMMU 20	10063143
ORD-E 20 + PG11	10064699

23.05.2026

Your Contact:

WISKA Hoppmann GmbH

Kisdorfer Weg 28 · 24568 Kaltenkirchen · Germany

☎ +49-4191-508-0 · 📠 +49-4191-508-209

contact@wiska.de · www.wiska.com

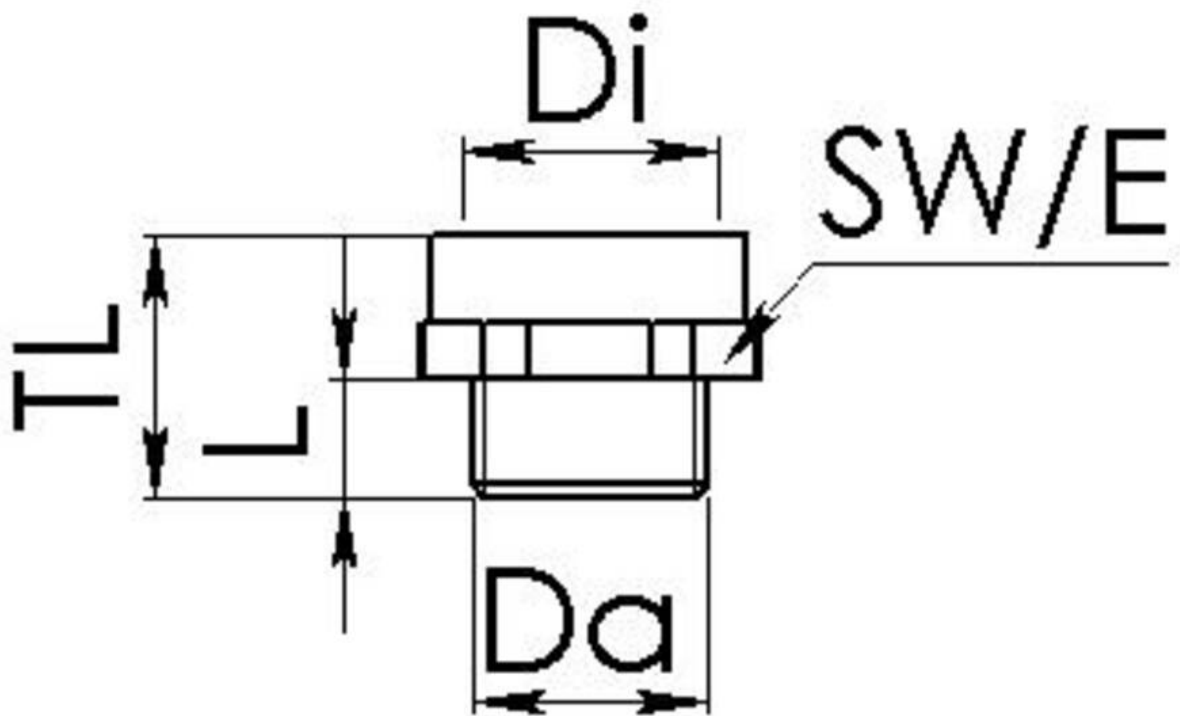

Your Contact:

WISKA Hoppmann GmbH

Kisdorfer Weg 28 · 24568 Kaltenkirchen · Germany

☎ +49-4191-508-0 · 📠 +49-4191-508-209

contact@wiska.de · www.wiska.com