

EX-KRM 16/12

Ex-reduction adaptor, polyamide, M16-M12

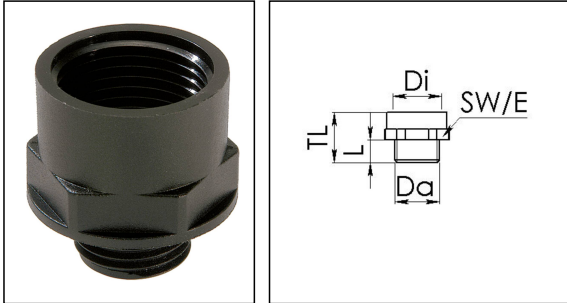

Products may differ in size, colour and appearance to those shown. If you require further information or customisation, please contact us directly.



| | |
|---------------------------------|--------------------------------|
| Material | Polyamide, fibre reinforced |
| Material sealing gasket | EPDM |
| Temp. range min | -40 °C |
| Temp. range max | 75 °C |
| Protection class | IP66 / IP68 (5 bar 30 min) |
| Type of protection | Ex eb, Ex tb |
| Ex-Certificate | IECEx, ATEX |
| Thread type outer | M |
| Ø outer thread | 16 |
| Lead outer | 1,5 |
| Length screw-in thread L | 9 mm |
| Thread type inner | M |
| Ø inner thread | 12 |
| Lead inner | 1,5 |
| Length internal thread | 15,5 mm |
| Key width SW | 20 mm |
| Collar diameter (E) | 23 mm |
| Total length TL | 27 mm |
| Form | A |
| Product Color | RAL 9005 |
| Equipment | Incl. connection thread gasket |
| Order no. RAL 9005 | 10064720 |
| Type | EX-KRM 16/12 |
| Packing unit | 100 |
| EAN number | 4007685647205 |

Your Contact:

WISKA Hoppmann GmbH

Kisdorfer Weg 28 · 24568 Kaltenkirchen · Germany

☎ +49-4191-508-0 · 📠 +49-4191-508-209

contact@wiska.de · www.wiska.com

| | |
|----------------------------|----------|
| Tariff number | 39269097 |
| ETIM-Classification | EC000938 |

Recommended accessories

| | |
|-------------------|----------|
| EMUG 16 BK | 10061781 |
|-------------------|----------|

12.05.2026

Your Contact:

WISKA Hoppmann GmbH

Kisdorfer Weg 28 · 24568 Kaltenkirchen · Germany

☎ +49-4191-508-0 · 📠 +49-4191-508-209

contact@wiska.de · www.wiska.com

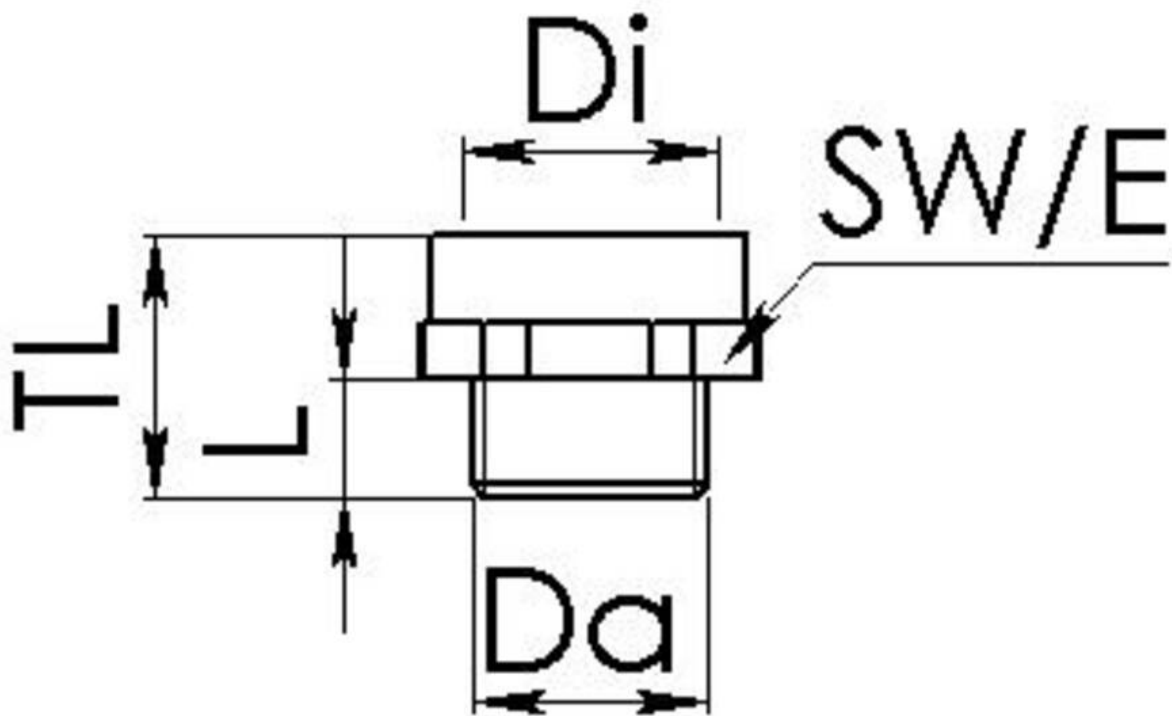

Your Contact:

WISKA Hoppmann GmbH

Kisdorfer Weg 28 · 24568 Kaltenkirchen · Germany

☎ +49-4191-508-0 · 📠 +49-4191-508-209

contact@wiska.de · www.wiska.com