

## BMCG-PVC-S-12-BK-GT

Conduit galvanized steel PVC coated greater temperature range RAL 9005 NW12

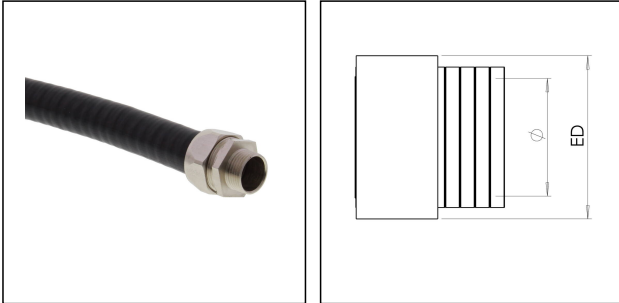

Products may differ in size, colour and appearance to those shown. If you require further information or customisation, please contact us directly.



<b>Material</b>	galvanized steel
<b>Sheathing material 1st coating</b>	PVC
<b>Surface</b>	smooth
<b>Product Color</b>	RAL 9005
<b>Protection class</b>	IP67
<b>Temp. range min</b>	-40 °C
<b>Temp. range max</b>	105 °C
<b>Operational areas</b>	Hygienic design, Mechanical plant engineering
<b>NW</b>	12
<b>External diameter ED</b>	18 mm
<b>Ø inside</b>	12 mm
<b>Bending radius R</b>	60 mm
<b>Type</b>	BMCG-PVC-S-12-BK-GT
<b>WISKA-Order no.</b>	10109040
<b>Packing unit</b>	30 m
<b>EAN number</b>	4007686079753
<b>Tariff number</b>	83071000
<b>ETIM-Classification</b>	EC001179

### Recommended accessories

<b>EMBMFS-S-12-16</b>	10109091
<b>EMBMFS-S-12-20</b>	10109093

23.05.2026

Your Contact:

**WISKA Hoppmann GmbH**

Kisdorfer Weg 28 · 24568 Kaltenkirchen · Germany

☎ +49-4191-508-0 · 📠 +49-4191-508-209

contact@wiska.de · www.wiska.com

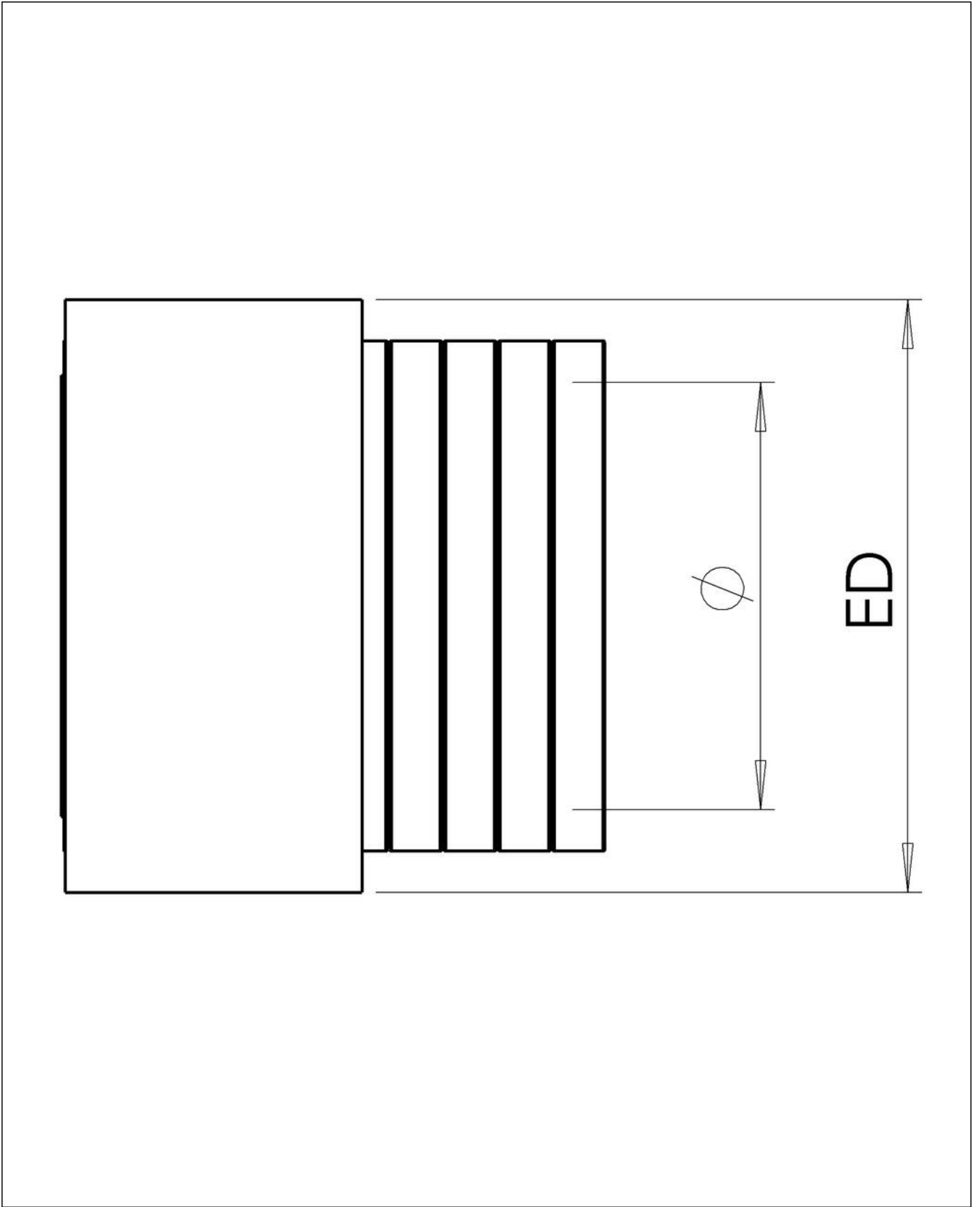

Your Contact:  
**WISKA Hoppmann GmbH**  
Kisdorfer Weg 28 · 24568 Kaltenkirchen · Germany  
☎ +49-4191-508-0 · 📠 +49-4191-508-209  
contact@wiska.de · www.wiska.com

Other technical data on request / subject to change without notice