

5010-PU-1x220W-230-AA-E01

Ballast Unit for LED Floodlight 5010 1x220W

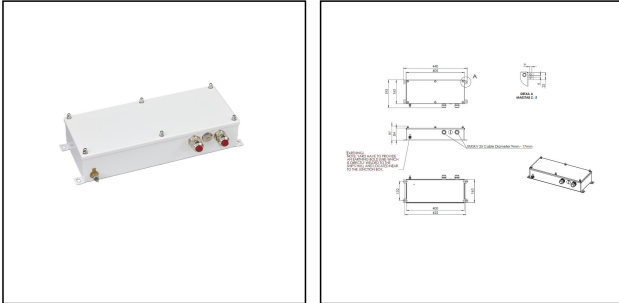

Products may differ in size, colour and appearance to those shown. If you require further information or customisation, please contact us directly.

WISKA-Order no.	10113096
Type	5010-PU-1x220W-230-AA-E01
Material	Stainless steel
Wattage	220 W
Power[^]	1 x 220 W
Voltage min. (V)	198 V
Voltage max. (V)	264 V
Type of Voltage	AC / DC
Frequence	50/60 Hz
Protection class	IP66 / IP67
Operational areas	Outdoor
Temp. range min	-25 °C
Temp. range max	45 °C
Mounting	Wall
Lightsource	LED
System Lifetime	100000 h
Type of cable gland	M 25 x 1,5
Material cable gland	Brass nickel-plated
Ø cable diameter min	9 mm
Ø cable diameter max	17 mm
External dimensions LxWxH	440 x 160 x 90 mm
Colour	White
Surface	Powder coated
Weight	5 kg
Tariff number	85041080

Your Contact:

WISKA Hoppmann GmbH

Kisdorfer Weg 28 · 24568 Kaltenkirchen · Germany

☎ +49-4191-508-0 · 📠 +49-4191-508-209

contact@wiska.de · www.wiska.com

Remarks:

D4i-certificated ballast unit

The maximum cable length between the ballast unit and the floodlight must not exceed 50 metres.

Spare parts

SP-5010-PU-1x220W-230 Mounting plate	22001429
SP-5010 LED Driver 220W	22001431

12.05.2026

Your Contact:

WISKA Hoppmann GmbH

Kisdorfer Weg 28 · 24568 Kaltenkirchen · Germany

☎ +49-4191-508-0 · 📠 +49-4191-508-209

contact@wiska.de · www.wiska.com

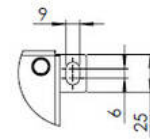
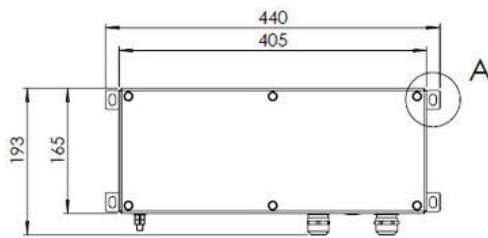

DETAIL A
MAßSTAB 2 : 5

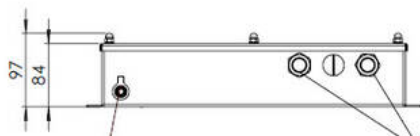

EMSKV 25 Cable Diameter 9mm - 17mm

EARTHING!
NOTE: YARD HAVE TO PROVIDE AN EARTHING BOLD (M8) WHICH IS DIRECTLY WELDED TO THE SHIP'S HULL AND LOCATED NEAR TO THE JUNCTION BOX.

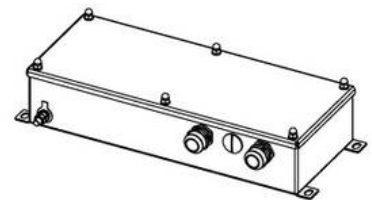
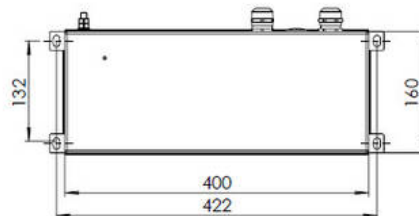

Your Contact:

WISKA Hoppmann GmbH

Kisdorfer Weg 28 · 24568 Kaltenkirchen · Germany

☎ +49-4191-508-0 · 📠 +49-4191-508-209

contact@wiska.de · www.wiska.com