

OPERATING INSTRUCTIONS

EX camera

CH EX 260-(##)-#-##-M##-#-##m

Contents

1. ABOUT THESE INSTRUCTIONS	3
1.1 Symbols and guidance signs in these instructions	3
1.2 Who are these instructions for?	3
2. SAFETY	3
2.1 Operating conditions	3
2.2 Safety instructions	3
2.3 Notes on the use in EX areas	4
3. AN OVERVIEW OF THE UNIT	5
3.1 Technical data	5
3.2 Applications	6
4. INSTALLATION	6
4.1 Mounting	6
4.2 Electrical connection	6
4.3 Connection of the exterior equipotential bonding	6
4.4 Set up and operation	7
5. Maintenance	7
6. Repair / Reconditioning	7
7. DISPOSAL	8
8. ACCESSORIES	8
8.1 Mounting foot	9
8.2 Junction box	10
8.3 Water tank	10
9. SPARE PARTS	9
10. EXAMINATION CERTIFICATE	10
11. IECEX CERTIFICATE	11
12. DECLARATION OF CONFORMITY	12

1. About these instructions

1.1 Symbols and guidance signs in these instructions



Danger! There is a risk to life and limb if the warning is not followed.

- **Enumerations** begin with an enumeration line.



Information from the manufacturer begins with an i.

1.2 Who are these instructions for?

When working in hazardous areas the safety of personnel and plant depends on complying with all relevant safety regulations. Fitting and maintenance staff working on such installations therefore have a particular responsibility. They require precise knowledge of the applicable rules and regulations.

These instructions give a brief summary of the most important safety measures. They supplement the corresponding regulations that the responsible staff must study.

2. Safety

The following safety instructions have to be strictly followed! Otherwise you put yourself and others in danger.

2.1 Operating conditions



Commissioning! Before you start operating the camera, make sure that:

- The camera is not damaged
- The seals are attached
- The camera is securely mounted
- The connection cable is not tangled
- That the conditions and information in these instructions and the parameters on the type plate are followed

2.2 Safety instructions



Only use the camera for its approved intended purpose. Ensure that the maximum temperature range (T_a) is not exceeded during installation and operation.



Incorrect or improper use or non-compliance with the information in these operating instructions invalidates its warranty.



Changes and alterations to the camera that adversely affect the explosion protection are not permitted. The cable- and line inlet as well as the screw plugs may not be altered.



The camera may only be operated in an undamaged and clean condition.



The responsibility in respect of proper use of these plug devices with reference to the basic conditions existing in the plant lies with the operator alone.

2.3 Notes on the use in EX areas

The camera conforms to the following regulations and standards:

- Directive 2014/34/EU
- IEC 60079-0:2017
- IEC 60079-1:2014
- IEC 60079-31:2013
- EN 60079-0:2012+A11:2011
- EN 60079-1:2014
- EN 60079-31:2014

The CH EX 260 type camera is certified for use in explosive areas in zones 1, 21, 2 and 22.

We will provide a copy of the EU Type-Test Certificate with the relevant annex on request.



For EPL Db: The explosion-proof camera type CH EX 260-(##)-#-##-M##--#-##m must be protected against electrostatic charge.



Screws for fastening the pressure-resistant housing may only be replaced by original screws from the manufacturer (strength A2-70).



Connecting cables

- Must be installed and connected in accordance with the applicable installation regulations.
- Must be connected either outside the hazardous area or inside the hazardous area in an enclosure with a suitable type of explosion protection.
- Must be permanently installed on site.
- Must have a strain relief.
- The camera is supplied via a permanently connected cable. The cable may only be replaced or modified by the manufacturer.

3. An overview of the unit

3.1 Technical data

Dimensional sketch:

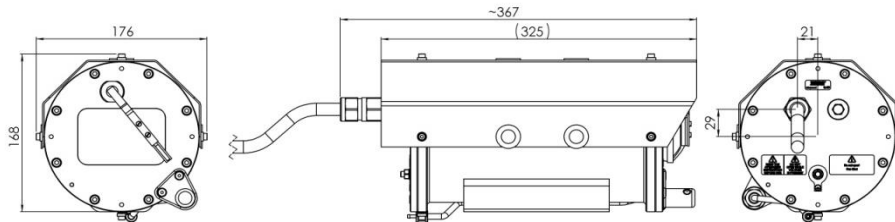



Figure 1: dimensional sketch of the camera

Type key:

CH	EX	260	- (##)	- #	- ##	- M##	- #	- ##m
								Länge des Anschlusskabels
								Angabe der Gehäuseoberfläche (Farbe)
								Gewindegröße der Kabelverschraubung
								Kameramodul 01 = cameramodul FCB-EX980P 02 = cameramodul Q1755 03 = cameramodul ZN-M2AF 04 = cameramodul FCB-EX2400/P 05 = cameramodul SDZ2030 06 = cameramodul SDZ4032
								Angabe der Montagerichtung U = stehend (unten) D = hängend (oben) L = links R = rechts
								WW = Optional Angabe "Wash and Wipe" W = Optional Angabe "Wash"
								Produktbezeichnung

Explosion protection:

 II 2 G Ex db IIC T6 Gb

 II 2 D Ex tb IIIC T85°C Db

Ambient temperature:

-30°C ≤ Ta ≤ +55°C

Test certificate:

IECEx TUN 13.0023X

TÜV 10 ATEX 381435 X

Housing material: Stainless steel 1.4571 (AISI316Ti / SUS316TiTp), stainless steel 1.4301 (AISI304 /V2a) powder-coated

Protection rating in accordance with IEC 60529: IP 66/68(0,2bar, 30min)

Weight (without mounting foot): CH EX 260 →7.2kg
CH EX 260-WW →7.4kg



Please consult the manufacturer if operating conditions are non-standard.

3.2 Applications



The camera serves to monitor spaces and areas in explosive areas, of the zones 1, 21, 2 and 22.

4. Installation



Transport and storage are only permitted in the original packaging.

4.1 Mounting

Direct mounting

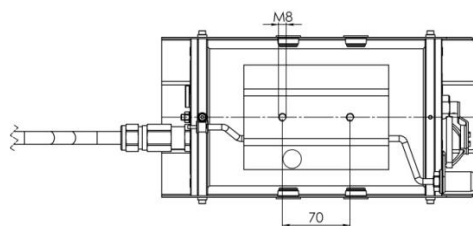

Figure 2: direct mounting connecting dimensions

Mounting with D300AS mounting foot

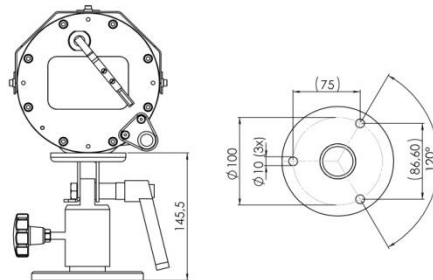

Figure 3: connecting dimensions for mounting with mounting foot

4.2 Electrical connection

The camera is delivered with a cable which is ready to connect. The connection to the junction box (see point 8.2 of these instructions) is performed on-site and should be carried out by suitably trained personnel.



Connecting cables

- Must be installed and connected in accordance with the applicable installation regulations.
- Must be connected either outside the hazardous area or inside the hazardous area in an enclosure with a suitable type of explosion protection.
- Must be permanently installed on site.
- Must have a strain relief.
- The camera is supplied via a permanently connected cable. The cable may only be replaced or modified by the manufacturer.

4.3 Connection of the exterior equipotential bonding

An exterior equipotential bond must be made with the camera. The connector is

located on the rear of the camera and is marked accordingly.

The cable which is to be used must have a cross-section of 4 mm² and has a size 6 - 6 solderless terminal in accordance with DIN 46237 for connection to the camera.

For secure installation of the solderless terminal the following tool should be used:

- No. 10 6000 crimping pliers with crimping profile inserts no. 10 6010 from CIMCO (www.cimco.de)
- or
- crimping tool no. 97 21 215 from KNIPEX (www.knipex.de)

4.4 Set up and operation

Observe the following during installation and operation:

- National safety regulations
- National accident prevention regulations
- National fitting and installation regulations (e.g. IEC 60079-14)
- Generally recognized technical regulations
- Safety guidelines in these operating instructions
- Characteristic values on the locking screws

Any damage can invalidate the explosion protection

5. Maintenance



Observe the relevant national regulations for the country of use!



The camera may also not be opened for maintenance purposes, otherwise the protective gas contained inside will escape.

The following points shall be checked during maintenance:

- Observation of the approved temperatures
- (according to IEC 60079-0 and the instructions on the camera type plate)
- Cracks in the cable gland
- Cracks and damage to the front glass
- Damage to the gaskets
- Screw connections are properly seated

5.1 Cleaning



For EPL Db: The explosion-proof camera type CH EX 260-(##)-#-##-M##--#-##m must be protected against electrostatic charge.

→ Cleaning must only be carried out with a clean slightly damp cloth

6. Repair / Reconditioning

Repair / reconditioning work may only be undertaken using WISKA original spare parts.

Repairs which affect the explosion protection, may only be carried out by WISKA in compliance with national mandatory legislation and regulations.



Changes or alterations to the camera are not permitted.



The screws used consist of A2 material with the strength class 70. These minimum values must be retained in case of exchange/replacement.

7. Disposal

Observe the national regulations for refuse disposal.



We are pleased to answer any special questions you may have.

8. Accessories



Only use original WISKA accessories.

8.1 Mounting foot

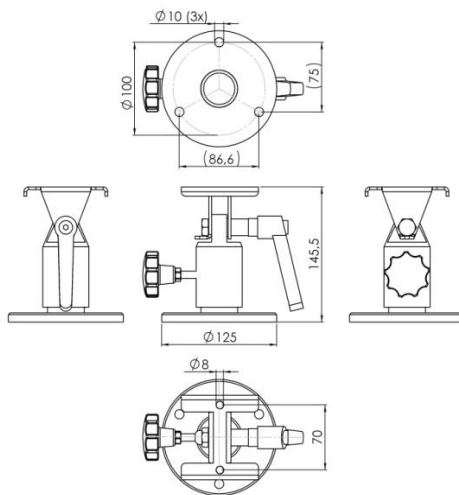

Figure 5: mounting foot

Material: Stainless steel 1.4305 (AISI303 / SUS303), powder coated
 Weight: 2.6kg

8.2 Junction box



The junction box does not have any explosion protection. For this reason it must be installed outside the area which is at risk of explosion.

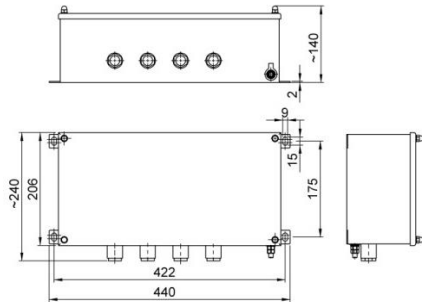

Figure 6: junction box

Material: Stainless steel 1.4301 (AISI304 / SUS304), powder coated
 Weight 8.5kg

8.3 Water tank



The water tank does not have any explosion protection. For this reason it must be installed outside the area which is at risk of explosion.

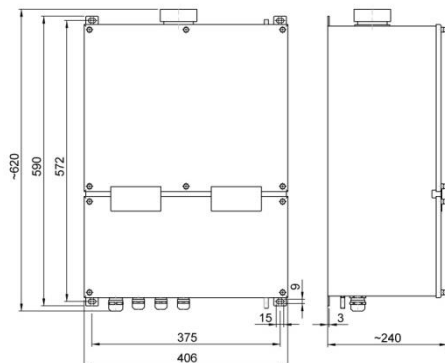

Figure 7: water tank

Material: Stainless steel 1.4301 (AISI304 / SUS304), powder coated
 Weight 23 kg (empty) 32.5 kg (full)

9. Spare parts



Only use original WISKA accessories.



Please do not hesitate to contact us if you require any further information or advice regarding spare parts.

10. Examination certificate

- Translation
- (1) **EU-Type Examination Certificate**
- (2) Equipment and protective systems intended for use in potentially explosive atmospheres, **Directive 2014/34/EU**
- (3) **Certificate Number** TÜV 10 ATEX381435 X **issue:** 00
- (4) for the product: Explosion proof camera
type CH EX 260-(##)-#-##-M##-#-##m
- (5) of the manufacturer: **WISKA Hoppmann GmbH**
- (6) Address: Kisdorfer Weg 28
24568 Kaltenkirchen
Germany
- Order number: 8000487566
Date of issue: 2019-01-28
- (7) The design of this product and any acceptable variation thereto are specified in the schedule to this EU-Type Examination Certificate and the documents therein referred to.
- (8) The TÜV NORD CERT GmbH, Notified Body No. 0044, in accordance with Article 17 of the Directive 2014/34/EU of the European Parliament and the Council of 26 February 2014, certifies that this product has been found to comply with the Essential Health and Safety Requirements relating to the design and construction of products intended for use in potentially explosive atmospheres given in Annex II to the Directive.
The examination and test results are recorded in the confidential ATEX Assessment Report No. 18 203 227726.
- (9) Compliance with the Essential Health and Safety Requirements has been assured by compliance with:
EN 60079-0:2012 + A11:2013 EN 60079-1:2014 EN 60079-31:2014
except in respect of those requirements listed at item 18 of the schedule.
- (10) If the sign "X" is placed after the certificate number, it indicates that the product is subject to the Specific Conditions for Use specified in the schedule to this certificate.
- (11) This EU-Type Examination Certificate relates only to the design, and construction of the specified product. Further requirements of the Directive apply to the manufacturing process and supply of this equipment. These are not covered by this certificate.
- (12) The marking of the product shall include the following:

 **II 2 G Ex db IIC T6 Gb**
II 2 D Ex tb IIIC T85°C Db

TÜV NORD CERT GmbH, Langemarckstraße 20, 45141 Essen, notified by the central office of the countries for safety engineering (ZLS), Ident. Nr. 0044, legal successor of the TÜV NORD CERT GmbH & Co. KG Ident. Nr. 0032

The head of the notified body

Reder: 



Hanover office, Am TÜV 1, 30519 Hannover, Tel. +49 511 998-61455, Fax +49 511 998-61590

This certificate may only be reproduced without any change, schedule included.
Excerpts or changes shall be allowed by the TÜV NORD CERT GmbH

P17-F-011 Rev. 01/04.16

page 1/4

11. IECEx certificate

		<h1>IECEX Certificate of Conformity</h1>	
INTERNATIONAL ELECTROTECHNICAL COMMISSION IEC Certification Scheme for Explosive Atmospheres <small>for rules and details of the IECEx Scheme visit www.iecex.com</small>			
Certificate No.:	IECEX TUN 13.0023X	Issue No: 2	Certificate history: Issue No. 2 (2019-02-08) Issue No. 1 (2014-07-22) Issue No. 0 (2013-08-07)
Status:	Current	Page 1 of 5	
Date of Issue:	2019-02-08		
Applicant:	WISKA Hoppmann GmbH Kisdorfer Weg 28, 24568 Kallenkirchen Germany		
Equipment:	Explosion proof Camera		
Optional accessory:	CH EX 260-(##)-##-M##-###m		
Type of Protection:	Protection by flameproof enclosures "d"; Equipment dust ignition protection by enclosure "t"		
Marking:	Ex db IIC T6 Gb Ex Ib IIIC T85°C Db		
Approved for issue on behalf of the IECEx Certification Body:	Christian Roder Head of the IECEx Certification Body		
Position:			
Signature: (for printed version)			
Date:	2019-02-08		
1. This certificate and schedule may only be reproduced in full. 2. This certificate is not transferable and remains the property of the issuing body. 3. The Status and authenticity of this certificate may be verified by visiting the Official IECEx Website.			
Certificate issued by:			
TÜV NORD CERT GmbH Hanover Office Am TÜV 1, 30519 Hannover Germany			
			

12. Declaration of conformity

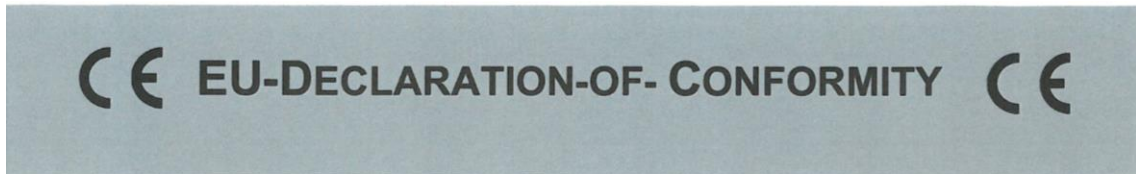

WISKA Hoppmann GmbH
 Kisdorfer Weg 28
 24568 Kaltenkirchen
 Germany



declares that the following product:

Product designation: Camera
 Type designation: CH EX 260 -(##) - # - ## - M## - # - ##m
 Approval number: TÜV 10 ATEX 381435 X
 Description: Camera for CCTV systems

corresponds to all the relevant provisions of the directives listed below and valid harmonized and / or international and national standards - including all applicable changes at this time of issuing this document.

Directive	Standard
2014/35/EU Electrical apparatus (Low voltage directive)	Not applicable acc. To chapter 1, article 1
2014/34/EU Equipment and protective systems intended for use in potentially explosive atmospheres (ATEX)	EN 60079-0:2012+A11:2011 (IEC 60079-0:2017) EN 60079-1:2014 (IEC 60079-1:2014) EN 60079-31:2014 (IEC 60079-31:2013)
2014/30/EU Electromagnetic compatibility (EMC directive)	EN 61000-6-2:2006 EN 61000-6-4:2011
2011/65/EU RoHS (Restriction of the use of hazardous substances directive)	EN 50581:2013-02

Name and address of the person who is authorized to compile the technical documentation together: Katrin Reuter-Zunft
 WISKA Hoppmann GmbH
 Kisdorfer Weg 28
 24568 Kaltenkirchen / Germany

Kaltenkirchen, 2019-03-28

Bernd Günay
 Head of Development CCTV



Page intentionally left blank

WISKA Hoppmann GmbH

Kisdorfer Weg 28
24568 Kaltenkirchen
Germany

☎ +49 (0) 4191/508-0

📠 +49 (0) 4191/508-129

contact@wiska.de

www.wiska.com

TRANSLATION OF THE ORIGINAL
Subject to alteration!