

Instruções de uso - Operating instructions - Mode d'emploi

Prensa-cabo

Cable glands

Entrées de câbles

E*SKEZ(-L)(-**) **(-**) (LT) (*****)

ESKEZ(-L)(-*) **

M*SKEZ(-L)(-**) ** (LT) (*****)

N*SKEZ(-L)(-**) ** (LT) (*****)

P*SKEZ(-L)(-**) **_** (LT) (*****)



ATEX

UK
CA



WISKA Hoppmann GmbH

Kisdorfer Weg 28 • D-24568 Kaltenkirchen

Tel. / Phone / Tél. +49 (0) 4191 508-100 • Fax +49 (0) 4191 508-249

E-Mail wiska@wiska.de • Internet www.wiska.de

Instruções de operação

Aplicação

A prensa-cabo serve para a conexão de cabos e linhas não assentes no meio de operação elétrica do tipo de proteção contra ignição Segurança aumentada "e".

Objetivo desse manual Ao trabalhar em atmosferas explosivas, a segurança de pessoas e das instalações depende do cumprimento de todos os regulamentos de segurança relevantes. O pessoal de montagem e de manutenção que trabalha nesse tipo de instalações tem, portanto, uma responsabilidade especial. O pré-requisito para isso é o conhecimento preciso das regras e dos regulamentos aplicáveis. Esse manual resume brevemente as medidas de segurança mais importantes. Ele complementa os respetivos regulamentos que o pessoal responsável é obrigado a estudar.

Reserva-se o direito a alterações.



Avisos de segurança Safety instructions Consignes de sécurité

Utilize exclusivamente a prensa-cabo para o fim de uso admissível.

O uso incorreto ou não autorizado e o não cumprimento das instruções desse manual de operação excluem qualquer garantia de nossa parte.

Não são permitidas modificações e alterações nas prensa-cabos que afetam a proteção contra explosões.

A prensa-cabo somente podem ser operadas em estado não danificado e limpo.

No caso de montagem e de operação, deve observar-se o seguinte:

- normas de segurança nacionais;
- normas de prevenção de acidentes nacionais
- regulamentos nacionais de montagem e de construção (p. ex., IEC 60079-14)
- normas geralmente reconhecidas da técnica;
- avisos de segurança deste manual de instruções;
- Valores característicos nas prensa-cabos

Qualquer dano pode invalidar a proteção Ex

A prensa-cabo **SKEZ(-L)(-4) **(-) (LT) EMC-* foi projetada para uso com cabos shieldados.**



Teremos o prazer de lhe enviar uma cópia do certificado de exame de tipo CE junto com o anexo associado, mediante solicitação. If required, we will provide a copy of the Type-Test Certificate with the relevant annex. Une copie du certificat de conformité aux normes ainsi que les annexes correspondantes sont disponibles sur simple demande.

Operating instructions

Application

The cable gland is used to bring unfixed cables and leads into electrical equipment with explosion protection type 'e' – Increased Safety.

Purpose of these instructions

Working in hazardous areas, the safety of personnel and plant depends on complying with all relevant safety regulations. Assembly and maintenance staff working on installations therefore have a particular responsibility. They require precise knowledge of the applicable standards and regulations. These instructions give a brief summary of the most important safety measures. It supplements the corresponding regulations which the staff responsible must study.

Subject to alteration.

Use the cable gland only for its intended purpose. Incorrect or impermissible use or non-compliance with these instructions invalidates our warranty provision. No changes to the device impairing its explosion protection are permitted. Use the cable glands only if they are clean and undamaged.

Observe the following during installation and operation:

- national safety regulations
- national accident prevention regulations
- national installation regulations (e.g. IEC 60079-14)
- generally recognized technical regulations
- safety guidelines in these operating instructions
- characteristic values given on the cable glands

Any damage can invalidate the Ex-protection.

Cable gland type **SKEZ(-L)(-4) **(-) (LT) EMV-* is for use with shielded cables.**

Mode d'emploi

Utilisation

Les entrées de câbles sont destinées au passage des câbles non fixes dans les équipements électriques en Sécurité Augmentée «e».

Objet du présent mode d'emploi

Lors du travail dans des zones à risque d'explosion, la sécurité des personnes et des installations dépend du respect de toutes les consignes de sécurité correspondantes. Le personnel chargé du montage et de la maintenance sur ces équipements possède à cet égard une grande responsabilité et doit connaître parfaitement les prescriptions et dispositions légales en vigueur. Le présent mode d'emploi résume de façon concise les mesures de sécurité les plus importantes. Il ne peut en aucun cas se substituer aux prescriptions correspondantes, dont l'étude demeure obligatoire pour le personnel responsable.

Sous réserve de modifications.

Les entrées de câbles ne doivent être utilisées que pour l'application pour laquelle elle ont été prévues. Une utilisation défectueuse ou anormale ainsi que le non-respect des consignes du présent mode d'emploi excluent toute clause de garantie. Les modifications sur les entrées de câbles, susceptibles d'entraver la protection antidéflagrante, ne sont pas autorisées. Ne pas monter les entrées de câbles si elles sont endommagées ou sales.

Lors du montage et du fonctionnement, veuillez observer les points suivants:

- les prescriptions nationales de sécurité
 - les prescriptions nationales en matière de prévention des accidents
 - les instructions nationales de montage (par. Ex. CEI 60079-14)
 - les règles de l'art dans le domaine technique
 - les consignes de sécurité du présent mode d'emploi
 - les caractéristiques techniques indiquées sur les entrées de câbles
- Toute détérioration de matériel peut avoir pour conséquence de rendre inopérante la protection antidéflagrante.

****SKEZ(-L)(-4) **(-**) (LT) EMV-* sont destinées à l'emploi de câbles armées.**

| Instruções de uso | | Operating instructions | | Mode d'emploi | |
|---|--|--|--|---|--|
| 1 Conformidade com as normas A inserção do cabo cumpre os seguintes regulamentos e normas: - Portaria INMETRO no. 115:2022 - Diretiva 2014/34/UE - IEC 60079-0:2017, Ed 7.0 (EN 60079-0:2018) - IEC 60079-7:2017, Ed 5.1 (EN 60079-7:2015) - IEC 60079-31:2022, Ed 3 (EN 60079-31:2014) - EN 62444:2013 A prensa-cabo do tipo **SKEZ(-L)(-**) **(-**) (LT) (****) é permitida para o uso em atmosferas explosivas das zonas 1, 21, 2 e 22. | | 1 Conformity to standards The cable gland complies with the following regulations and standards: - Directive 2014/34/EU - UKSI 2016:1107 (as amended by UKSI 2019:696) – Schedule 3A, Part 1 - IEC 60079-0:2017 (EN 60079-0:2018) - IEC 60079-7:2015 (EN 60079-7:2015) - IEC 60079-31:2013 (EN 60079-31:2014) - EN 62444:2013 Cable gland type **SKEZ(-L)(-**) **(-**) (LT) (****) is suitable for use in hazardous areas of Zones 1, 21, 2 and 22. | | 1 Conformité aux normes Les entrées de câbles sont conformes aux prescriptions et normes suivantes: - Directive 2014/34/UE - UKSI 2016:1107 (as amended by UKSI 2019:696) – Schedule 3A, Part 1 - IEC 60079-0:2017 (EN 60079-0:2018) - IEC 60079-7:2015 (EN 60079-7:2015) - IEC 60079-31:2013 (EN 60079-31:2014) - EN 62444:2013 L'utilisation des entrées de câbles type **SKEZ(-L)(-**) **(-**) (LT) (****) est autorisée en atmosphère explosive des zones 1, 21, 2 et 22. | |
| 2 Dados técnicos <u>Proteção contra explosões:</u> Certificado de inspeção: Material: *MSKEZ(-L)(-**) **(-**) (LT) (****) *SSKEZ(-L) **(-**) (LT) (****) *SKEZ(-L)-4 **(-**) (LT) (****) ESKEZ(-L)-* ** Temperatura ambiente e risco do perigo mecânico | | 2 Technical Data <u>Explosion protection:</u> II 2 G Ex eb IIC Gb / II 2 D Ex tb IIIC Db Test certificate: IECEx PTB 13.0052X, PTB 09 ATEX 1049 X, UL22UKEX2677X, UL Material: Latão/ brass / laiton Aço inoxidável/ Stainless steel / Acier special Aço inoxidável/ Stainless steel / Acier special Kunststoff 000000/ plastic / plastique Ambient temperature and risk of mechanical hazards: | | 2 Caractéristiques techniques <u>Protection antidéflagrante:</u> Certificat de conformité: UL-BR 21.1134X Matériau: 2.0401 (Ms58, CW614N, C 38500) 1.4305 (A2, X8CrNiS18-9, AISI 303) 1.4404 (A4, X2CrNiMo17-12-2, AISI 316L) Poliamida / polyamide / polyamide Température ambiante et risque de risques mécaniques: | |
| Variant of the cable gland / Variante des entrées de câbles **SKEZ(-L)(-**) **(-**) (****) **SKEZ(-L)(-**) **(-**) LT (****) ESKEZ(-L)-* ** Grau de proteção conforme a IEC 60529: Torques e faixas de aperto recomendados | | Ambient temperature / Température ambiante Risco do perigo mecânico / risk of mechanical hazards / risque de risques mécaniques elevado/ high / haut (7J) elevado/ high / haut (7J) baixo / low / faible (4J) Degree of protection to IEC 60529: IP66/68 (5bar, 30min) Recommended torques and clamping ranges: | | Material e cor dos selos / Material and color of the seals / Matériau et couleur des sceaux EPDM, preto / EPDM, black / EPDM, noir Silicone, vermelho e - ou azul / Silicone, red and - or blue / Silicon, rouge et - ou bleu EPDM, preto / EPDM, black / EPDM, noir Degré de protection d'après CEI 60529: Couples et serrages recommandés: | |
| Tamanho da passagem de cabo / Cable gland size / Filetage des entrées câbles E*SKEZ 16, E*SKEZ 12-16, M*SKEZ 16, N*SKEZ 3/8, P*SKEZ 7-16, P*SKEZ 9-16, P*SKEZ 11-16 E*SKEZ 20, E*SKEZ 16-20, M*SKEZ 18, N*SKEZ 1/2, P*SKEZ 11-20, P*SKEZ 13,5-20, P*SKEZ 16-20 ESKVZ-* 20 E*SKEZ 25, E*SKEZ 20-25, M*SKEZ 24, N*SKEZ 3/4, P*SKEZ 13,5-25, P*SKEZ 16-25, P*SKEZ 21-25 ESKVZ-* 25 E*SKEZ 32, E*SKEZ 25-32, M*SKEZ 30, N*SKEZ 1, P*SKEZ 21-32 ESKVZ-* 32 E*SKEZ 40, E*SKEZ 32-40, M*SKEZ 36, N*SKEZ 1 1/4, P*SKEZ 29-40 E*SKEZ 50, E*SKEZ 40-50, M*SKEZ 45, N*SKEZ 1 1/2, P*SKEZ 36-50, P*SKEZ 42-50 E*SKEZ 63, E*SKEZ 50-63, M*SKEZ 56, N*SKEZ 2, P*SKEZ 48-63 Um disco inserido, que deve ser removido durante a instalação, serve como proteção contra poeira até que o cabo seja instalado. | | Rosca de conexão / Connection thread / Filet de raccordement M [Nm] 4,0 8,0 2,3 10,0 3,0 20,0 4,5 20,0 30,0 40,0 The disc fitted to prevent the ingress of dust must be removed during installation. | | Porca de capa / Cap nut / Vis de serrage M [Nm] 4,0 8,0 1,5 10,0 2,0 20,0 3,0 20,0 30,0 40,0 Mordentes de aperto / Clamping jaws / mâchoire de serrage M [Nm] 0,3 0,4 0,4 0,4 0,4 0,5 0,5 0,5 0,6 0,6 Area dos terminais / Clamping range / Serrage [mm] 6,5 – 10 8 – 13 8 – 13 10 – 17 10 – 17 16 – 21 16 – 21 18 – 28 22 – 35 34 – 48 Une rondelle protège l'entrée de câbles de la poussière jusqu'au montage du câble. Elle doit être enlevée lors de l'installation. | |

3 Montagem

Esboço dimensionado

3 Fitting
Dimensions

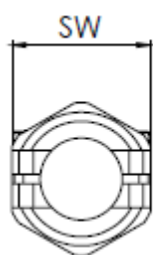

3 Montage

Plan d'encombrement

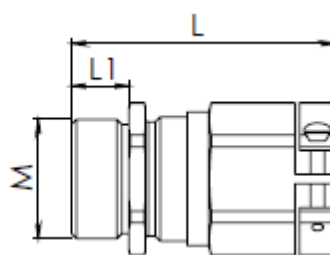

| Tipo / Type / Type | M | SW [mm] | Tipo normal / normal type / type normal | | Tipo em L / -L type / type -L | |
|--------------------------------|------------|------------|---|------------|-------------------------------|------------|
| | | | L [mm] | L1 [mm] | L [mm] | L1 [mm] |
| E*SKEZ(-**) 12-16 (LT)(****) | M12x1,5 | 20 | 34 - 42 | 5 | 41 - 49 | 12 |
| E*SKEZ(-**) 16 (LT)(****) | M16x1,5 | 20 | 34 - 42 | 5 | 41 - 49 | 12 |
| E*SKEZ(-**) 16-20 (LT)(****) | M16x1,5 | 24 | 36 - 44 | 5 | 43 - 51 | 12 |
| E*SKEZ 20(-**) (LT)(****) | M20x1,5 | 24 | 37 - 45 | 6 | 43 - 51 | 12 |
| E*SKEZ(-**) 20-25 (LT)(****) | M20x1,5 | 29 | 43 - 52 | 6 | 49 - 58 | 12 |
| E*SKEZ(-**) 25 (LT)(****) | M25x1,5 | 29 | 44 - 53 | 7 | 49 - 58 | 12 |
| E*SKEZ(-**) 25-32 (LT)(****) | M25x1,5 | 36 | 48 - 56 | 7 | 53 - 61 | 12 |
| E*SKEZ(-**) 32 (LT)(****) | M32x1,5 | 36 | 49 - 57 | 8 | 56 - 64 | 15 |
| E*SKEZ(-**) 32-40 (LT)(****) | M32x1,5 | 46 | 57 - 68 | 8 | 64 - 75 | 15 |
| E*SKEZ(-**) 40 (LT)(****) | M40x1,5 | 46 | 57 - 68 | 8 | 64 - 75 | 15 |
| E*SKEZ(-**) 40-50 (LT)(****) | M40x1,5 | 55 | 67 - 78 | 8 | 73 - 84 | 15 |
| E*SKEZ(-**) 50 (LT)(****) | M50x1,5 | 55 | 67 - 78 | 9 | 73 - 84 | 15 |
| E*SKEZ(-**) 50-63 (LT)(****) | M50x1,5 | 68 | 71 - 82 | 9 | 77 - 88 | 15 |
| E*SKEZ(-**) 63 (LT)(****) | M63x1,5 | 68 | 72 - 83 | 10 | 77 - 88 | 15 |
| ESKEZ-* 20 | M20x1,5 | 24 | 49 - 58 | 10 | 54 - 63 | 15 |
| ESKEZ-* 25 | M25x1,5 | 29 | 51 - 60 | 10 | 56 - 65 | 15 |
| ESKEZ-* 32 | M32x1,5 | 36 | 57 - 66 | 12 | 60 - 69 | 15 |
| M*SKEZ(-**) 16 (LT)(****) | M16x1,5 | 20 | 38 - 46 | 9 | --- | --- |
| M*SKEZ(-**) 18 (LT)(****) | M18x1,5 | 24 | 41 - 49 | 10 | --- | --- |
| M*SKEZ(-**) 24 (LT)(****) | M24x1,5 | 29 | 48 - 57 | 11 | --- | --- |
| M*SKEZ(-**) 30 (LT)(****) | M30x2 | 36 | 53 - 61 | 12 | --- | --- |
| M*SKEZ(-**) 36 (LT)(****) | M36x2 | 46 | 62 - 73 | 13 | --- | --- |
| M*SKEZ(-**) 45 (LT)(****) | M45x2 | 55 | 72 - 83 | 14 | --- | --- |
| M*SKEZ(-**) 56 (LT)(****) | M56x2 | 68 | 77 - 88 | 15 | --- | --- |
| N*SKEZ(-**) 3/8 (LT)(****) | NPT 3/8" | 20 | 42 - 50 | 13 | --- | --- |
| N*SKEZ(-**) 1/2 (LT)(****) | NPT 1/2" | 24 | 47 - 55 | 16 | --- | --- |
| N*SKEZ(-**) 3/4 (LT)(****) | NPT 3/4" | 29 | 53 - 62 | 16 | --- | --- |
| N*SKEZ(-**) 1 (LT)(****) | NPT 1" | 36 | 61 - 69 | 20 | --- | --- |
| N*SKEZ(-**) 1 1/4 (LT)(****) | NPT 1 1/4" | 46 | 69 - 80 | 20 | --- | --- |
| N*SKEZ(-**) 1 1/2 (LT)(****) | NPT 1 1/2" | 55 | 78 - 89 | 20 | --- | --- |
| N*SKEZ(-**) 2 (LT)(****) | NPT 2" | 68 | 83 - 94 | 21 | --- | --- |
| P*SKEZ(-**) 7-16 (LT)(****) | Pg7 | 20 | 34 - 42 | 5 | 41 - 49 | 12 |
| P*SKEZ(-**) 9-16 (LT)(****) | Pg9 | 20 | 34 - 42 | 5 | 41 - 49 | 12 |
| P*SKEZ(-**) 11-16 (LT)(****) | Pg11 | 20 | 35 - 43 | 6 | 41 - 49 | 12 |
| P*SKEZ(-**) 11-20 (LT)(****) | Pg11 | 24 | 37 - 45 | 6 | 43 - 51 | 12 |
| P*SKEZ(-**) 13,5-20 (LT)(****) | Pg13,5 | 24 | 37 - 45 | 6 | 43 - 51 | 12 |
| P*SKEZ(-**) 13,5-25 (LT)(****) | Pg13,5 | 29 | 43 - 52 | 6 | 49 - 58 | 12 |
| P*SKEZ(-**) 16-20 (LT)(****) | Pg16 | 24 / 29 | 37 - 45 | 6 | 43 - 51 | 12 |
| P*SKEZ(-**) 16-25 (LT)(****) | Pg16 | 29 | 43 - 52 | 6 | 49 - 58 | 12 |
| P*SKEZ(-**) 21-25 (LT)(****) | Pg21 | 29 / 36 | 44 - 53 | 7 | 49 - 58 | 12 |
| P*SKEZ(-**) 21-32 (LT)(****) | Pg21 | 36 | 52 - 60 | 7 | 60 - 68 | 15 |
| P*SKEZ(-**) 29-40 (LT)(****) | Pg29 | 46 | 58 - 69 | 8 | 65 - 76 | 15 |
| P*SKEZ(-**) 36-50 (LT)(****) | Pg36 | 55 | 67 - 78 | 9 | 73 - 84 | 15 |
| P*SKEZ(-**) 42-50 (LT)(****) | Pg42 | 55 | 68 - 79 | 10 | 73 - 84 | 15 |
| P*SKEZ(-**) 48-63 (LT)(****) | Pg48 | 68 | 72 - 83 | 10 | 77 - 88 | 15 |

3 Montagem

Medidas de conexão dos dispositivos

3 Fitting

Connection dimensions of the devices

3 Montage

Dimensions de raccordement des appareils

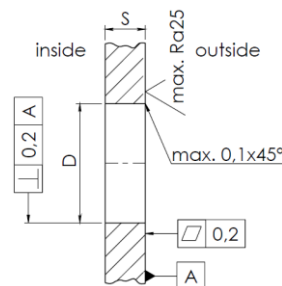
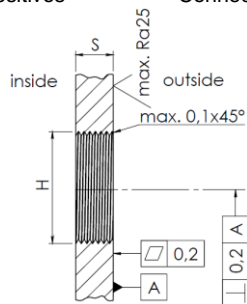

| Furo roscado / Threaded hole / Trou fileté | Norma da rosca / Thread standard / Norme de filetage | Espessura da parede com furo roscado / Wall thickness with threaded hole / Épaisseur de la paroi avec trou fileté | | Diâmetro do furo de passagem / Through hole diameter / À travers le diamètre du trou D [mm] | Espessura da parede com furo de passagem / Wall thickness with through-hole / Épaisseur de la paroi avec trou traversant | | | | | |
|--|---|---|---|---|--|---|--|--|--|--|
| | | Caixa metálica / Metal housings / Boîtier en métallique | Caixa em plástico / Plastic housings / Boîtier en plastique | | Caixa metálica / Metal housings / Boîtier en métallique | Caixa em plástico / Plastic housings / Boîtier en plastique | | | | |
| H | | | | | | | | | | |
| M12x1,5 – 6H | ISO 965-1 | ≥ 3mm | ≥ 3mm | 12,0+0,2 | ≥ 1mm | ≥ 2mm | | | | |
| M16x1,5 – 6H | | | | 16,0+0,2 | | | | | | |
| M18x1,5 – 6H | | | | 18,0+0,2 | | | | | | |
| M20x1,5 – 6H | | | | 20,0+0,2 | | | | | | |
| M24x1,5 – 6H | | | | 24,0+0,2 | | | | | | |
| M25x1,5 – 6H | | | | 25,0+0,2 | | | | | | |
| M30x2 – 6H | | | | 30,0+0,3 | | | | | | |
| M32x1,5 – 6H | | | | 32,0+0,3 | | | | | | |
| M36x2 – 6H | | | | 36,0+0,3 | | | | | | |
| M40x1,5 – 6H | | | | 40,0+0,3 | | | | | | |
| M45x2 – 6H | | | | 45,0+0,3 | | | | | | |
| M50x1,5 – 6H | | | | 50,0+0,3 | | | | | | |
| M56x2 – 6H | | | | 56,0+0,3 | | | | | | |
| M63x1,5 – 6H | 63,0+0,3 | | | | | | | | | |
| Pg 7 | DIN 40430 | ≥ 3mm | ≥ 3mm | 12,6+0,2 | ≥ 1mm | ≥ 2mm | | | | |
| Pg 9 | | | | 15,3+0,2 | | | | | | |
| Pg 11 | | | | 18,7+0,2 | | | | | | |
| Pg 13,5 | | | | 20,5+0,2 | | | | | | |
| Pg 16 | | | | 22,6+0,2 | | | | | | |
| Pg 21 | | | | 28,4+0,2 | | | | | | |
| Pg 29 | | | | 37,1+0,3 | | | | | | |
| Pg 36 | | | | 47,1+0,3 | | | | | | |
| Pg 42 | | | | 54,1+0,3 | | | | | | |
| Pg 48 | | | | 59,4+0,3 | | | | | | |
| NPT 3/8" | | | | | | | | | | |
| NPT 1/2" | | | | | | | | | | |
| NPT 3/4" | | | | | | | | | | |
| NPT 1" | | | | | | | | | | |
| NPT 1 1/4" | | | | | | | | | | |
| NPT 1 1/2" | | | | | | | | | | |
| NPT 2" | | | | | | | | | | |



Em caso de outras condições de operação que se desviem da norma, consulte o fabricante. /
Please consult the manufacturer if operating conditions are non-standard. /
En cas de conditions d'utilisation différentes, veuillez contacter le constructeur.

Instruções de uso

A responsabilidade relativa ao uso devido destes redutores, expansões e adaptadores com referência às condições básicas existentes na instalação recai exclusivamente sobre a empresa usuária.

O transporte e o armazenamento só são permitidos na embalagem original.

4 Colocação em serviço

Antes de colocar um aparelho em operação com a prensa-cabo, certifique-se de que

- a prensa-cabo não está danificada
- as prensa-cabos estão apertadas de acordo com os torques recomendados
- as prensa-cabos não usadas estão vedadas com os elementos de fecho adequados, por exemplo, tampões de fecho do tipo BS **, e furos não usados com os tampões roscados certificados conforme a diretiva 2014/34/UE
- os cabos estão inseridos corretamente
- as superfícies de apoio estão em face com as juntas

Operating instructions

The user alone is responsible for the appropriate use of this cable gland in consideration of the basic conditions existing at the plant.

Transport and storage is permitted only in the original packaging.

4 Commissioning

Before commissioning equipment fitted with cable glands, ensure that:

- the cable gland is not damaged
- the cable glands have been tightened to the recommended torque values
- unused cable and wire entries are sealed with suitable closing elements, e.g. closure plugs type BS **, and unused holes with certified locking screws
- the cables have been correctly brought in
- the gasket bearing areas are flat

Mode d'emploi

L'utilisation conforme aux dispositions de ces entrées de câbles, en tenant compte des conditions cadre existants dans l'installation, est laissé à la seule responsabilité de l'exploitant.

Le transport et le stockage sont autorisés uniquement en emballage d'origine.

4 Mise en service

Avant la mise en service d'un appareil avec des entrées de câbles, assurez-vous des points suivants:

- les entrées de câbles ne sont pas endommagées
- les entrées de câbles sont serrées conformément au couple recommandée
- les entrées de câble et de conduite inutilisées soient refermées avec des éléments appropriés (p.ex. bouchon de fermeture de type BS **) et à ce que les perçages inutilisés soient scellés avec des conformément bouchons filetés
- les câbles sont introduits correctement
- les surfaces de contact pour les joints sont planes

A instalação e a operação inadequadas invalidarão a garantia.

Improper installation and operation leads to loss of warranty.

Une installation et une exploitation incorrectes conduisent à la perte de la garantie.

5 Manutenção



Observe os regulamentos nacionais aplicáveis no país de atuação! /
Observe the relevant national regulations for your country! /
Observez les réglementation en vigueur dans le pays d'utilisation!

Nos trabalhos de manutenção devem ser verificados os seguintes pontos:

- Cumprimento das temperaturas admissíveis (conforme a EN 60079-0)
- Fissuras nos redutores, expansões e adaptadores
- Danos nas juntas

5 Maintenance

The following points must checked during maintenance:

- compliance with permitted temperatures (to IEC 60079-0)
- cracks in the cable gland
- damage to the gaskets

5 Maintenance

Lors des travaux d'entretien, les points suivants doivent être contrôlés:

- le maintien des températures autorisées (selon IEC 60079-0)
- la présence éventuelle de fissures sur les entrées de câbles
- la détérioration des joints d'étanchéité

6 Acessório/peças de reposição



Use apenas acessórios originais, bem como peças de reposição originais da empresa WISKA. /
Use only original spare parts as wie as original accessories made by WISKA. /
Utilisez uniquement des pièces de rechange at des accessoires d'origine de WISKA.



A WISKA oferece uma chave especial para apertar os prensa-cabos, cujo número de pedido pode ser encontrado no catálogo atual. /WISKA offers a special spanner for tightening cable glands, the order number of which can be found in our latest catalogue. /
Pour le montage des entrées de câbles WISKA propose une clé speciale, dont vous trouverez la référence dans le catalogue actuel.

Solicite ao pessoal de serviço da WISKA os acessórios originais adequados e as peças de reposição originais (como porcas de fixação, plugues, vedações).

Please ask the WISKA service personnel about suitable original accessories and spare parts (such as locknuts, plugs, seals). /

Vous pouvez vous procurer les accessoires d'origine appropriés ainsi que des pièces de rechange d'origine (p.ex. contre-écrous, bouchons, joints) auprès du personnel de service WISKA.

7 Tratamento e disposição de resíduos

7 Disposal

7 Réglementation concernant les déchets



Observe a política nacional de resíduos sólidos. /
Observe the national standard for refuse disposal. /
Respectez les réglementations nationales en matière d'élimination des déchets.



Teremos todo o prazer em responder a perguntas específicas. /
We are pleased to answer any special questions you may have. /
Nous sommes à votre disposition pour tout renseignement complémentaire.

Sollten Sie die Betriebsanleitung in einer der anderen Sprachen der Europäischen Gemeinschaft benötigen, wenden Sie sich bitte an Ihren WISKA-Vertreter.

Should you require the operating instructions in one of the other European Community languages, please feel free to contact your WISKA representative.

Si vous avez besoin des instructions de mise en service dans une autre langue de l'Union Européenne, prière de contacter votre Représentant WISKA.

En översättning av denna montageoch skötselinstruktion till annat EU-språk kann vid behov beställas från er WISKA representant.

En caso necesario podrá solicitar de su representante WISKA estas instrucciones de servicio en otro idioma de la Union Europea.

Montagevejledningen kan oversættes til andre EU-sprog og rekvireres hos deres WISKA leverandør.

Se desiderate la traduzione del manuale operativo in un'altra lingua della Comunità Europea potete richiederla al vostro rappresentante WISKA.

Tarvittaessa tämän käyttöohjeen käännös on saatavissa toisella EU:n kielellä Teidän WISKA-edustajaltanne.

Indien noodzakelijk kan de vertaling van deze gebruiksinstructie in een andere EU-taal worden opgevraagd bij uw WISKA-vertegenwoordiging.



(1) EU-TYPE EXAMINATION CERTIFICATE (Translation)

- (2) Equipment or Protective Systems Intended for Use in Potentially Explosive Atmospheres - Directive 2014/34/EU
(3) EU-Type Examination Certificate Number: PTB 09 ATEX 1049 X
(4) Product: Kabel- und Leitungseinführung Type **SKEZ(-L);(-
(5) Manufacturer: WISKA Hoppmann GmbH
(6) Address: Kisdorfer Weg 28, 24568 Kaltenkirchen, Germany
(7) This product and any acceptable variation thereto is specified in the schedule documents therein referred to.
(8) The Physikalisch-Technische Bundesanstalt, notified body No. 0102 in accordance with Directive 2014/34/EU of the European Parliament and of the Council, dates that this product has been found to comply with the Essential Health and Safety Requirements relating to the design and construction of products intended for use in potentially explosive atmospheres given in Annex II to the Directive.
(9) Compliance with the Essential Health and Safety Requirements has been as EN IEC 60079-0:2018, EN IEC 60079-7:2015/A1:2018, EN 60079-31
(10) If the sign "X" is placed after the certificate number, it indicates that the product complies with the conditions of use specified in the schedule to this certificate.
(11) This EU-Type Examination Certificate relates only to the design and construction of the product in accordance with the Directive 2014/34/EU. Further requirements of manufacturing process and supply of this product. These are not covered by this certificate.
(12) The marking of the product shall include the following:

II 2 G Ex eb IIC Gb
II 2 D Ex tb IIIC Db

Konformitätsbewertungsstelle, Sektor Explosionsschutz
On behalf of PTB.



EU-Type Examination Certificates without signature and official stamp shall not be valid. The only valid alteration. Extracts or alterations are subject to approval by the Physikalisch-Technische Bundesanstalt.

Physikalisch-Technische Bundesanstalt • Bundesallee 100 • 38116 Braunschweig

IECEx Certificate of Conformity
INTERNATIONAL ELECTROTECHNICAL COMMISSION
IEC Certification System for Explosive Atmospheres
Certificate No.: IECEx PTB 13.0052X Page 1 of 4
Status: Current Issue No: 2
Date of Issue: 2022-05-10
Applicant: WISKA Hoppmann GmbH, Kisdorfer Weg 28, 24568 Kaltenkirchen, Germany
Equipment: Cable gland type **SKEZ(-L);(-) **(-) (LT) (****)
Optional accessory:
Type of Protection: "eb", "tb"
Marking: Ex eb IIC Gb, Ex tb IIIC Db
Approved for issue on behalf of the IECEx Certification Body: Dr.-Ing. Detlev Markus, Head of Section "Explosion Protection"
Date: 09.05.22

UNITED KINGDOM CONFORMITY ASSESSMENT
UK-TYPE EXAMINATION CERTIFICATE

- (1) Product or Protective System Intended for use in Potentially Explosive Atmospheres UKSI 2016:1107 (as amended by UKSI 2019:696) - Schedule 3A, Part 1
(2) UK-Type Examination Certificate No.: UL22UKEX2677X Rev. 0
(3) Product: Cable gland type **SKEZ(-L);(-) **(-) (LT) (****)
(4) Manufacturer: WISKA Hoppmann GmbH
(5) Address: Kisdorfer Weg 28, 24568 Kaltenkirchen, Germany
(6) This product and any acceptable variation thereto are specified in the schedule to this certificate and the documents therein referred to.
(7) UL International (UK) Ltd, Approved Body number 0843, in accordance with Regulation 44 of the Equipment and Protective Systems Intended for Use in Potentially Explosive Atmospheres Regulations 2016, UKSI 2016:1107 (as amended by UKSI 2019:696), certifies that this product has been found to comply with the Essential Health and Safety Requirements relating to the design and construction of products intended for use in potentially explosive atmospheres given in Schedule 1 of the Regulations. The examination and test results are recorded in the confidential report DE/PTB/EX/13.0075/02.
(8) Compliance with the Essential Health and Safety Requirements has been assured by compliance with: EN IEC 60079-0:2018 EN IEC 60079-7:2015/A1:2018 EN 60079-31:2014
(9) Except in respect of those requirements listed at section 19 of the schedule to this certificate.
(10) If the sign "X" is placed after the certificate number, it indicates that the product is subject to the Specific Conditions of Use specified in the Schedule to this certificate.
(11) This UK-TYPE EXAMINATION CERTIFICATE relates only to the design and construction of the specified product. Further requirements of the Regulations apply to the manufacturing process and supply of this product. These are not covered by this certificate.
(12) The marking of the product shall include the following:

II 2 G Ex eb IIC Gb
II 2 D Ex tb IIIC Db

Certification Officer: Andrew Moffat

Date of issue: 2023-01-31

Approved Body: UL International (UK) Ltd Unit 1-3 Horizon Kingsland Business Park Wade Road, Basingstoke RG24 8AH, UK Phone: +44 (0)1256 312100



EU DECLARATION OF CONFORMITY



WISKA Hoppmann GmbH
Kisdorfer Weg 28
24568 Kaltenkirchen
Germany



KCE1-21002-0

Declares under its sole responsibility that:

Table with 2 columns: Field (Product designation, Type designation, Description, Approval number, Production Quality Assessment, Notification, Information about the product, Marking, Ambient temperature) and Value (Cable gland, **SKEZ(-L);(-) **(-) (LT) (****), Cable gland for electrical installation, PTB 09 ATEX 1049 X, PTB 03 ATEX Q044, II 2 G Ex eb IIC Gb, II 2 D Ex tb IIIC Db, Standard Type: -40°C ... +75°C, LT Type: -60°C ... +75°C, Plastic: -20°C ... +75°C)

corresponds to all the relevant provisions of the directives listed below and valid harmonized and / or international and national standards - including all applicable changes at this time of issuing this document.

Table with 2 columns: Regulation and Standard. Regulations include 2014/34/EU, 2011/65/EU, and 2012/19/EU. Standards include EN IEC 60079-0:2018, EN IEC 60079-7:2015, EN 60079-31:2014, EN 62444:2013, and EN IEC 63000:2018.

WISKA Hoppmann GmbH
Kaltenkirchen, Germany

Signature of Head of Engineering & Design

2023-02-24

Head of Engineering & Design

DECLARATION OF CONFORMITY



WISKA Hoppmann GmbH
Kisdorfer Weg 28
24568 Kaltenkirchen
Germany



KGB1-21002-0

Declares under its sole responsibility that:

Table with 2 columns: Field (Product designation, Type designation, Description, Approval number, Production Quality Assessment, Notification, Information about the product, Marking, Ambient temperature) and Value (Cable gland, **SKEZ(-L);(-) **(-) (LT) (****), Cable gland for electrical installation, UL22UKEX2677X Rev. 0, UL22UKQAN19164, II 2 G Ex eb IIC Gb, II 2 D Ex tb IIIC Db, Standard Type: -40°C ... +75°C, LT Type: -60°C ... +75°C, Plastic: -20°C ... +75°C)

corresponds to all the relevant provisions of the directives listed below and valid harmonized and / or international and national standards - including all applicable changes at this time of issuing this document.

Table with 2 columns: Regulation and Standard. Regulations include UKSI 2016:1107, S.I. 2012 No. 3032, and 2012/19/EU. Standards include EN IEC 60079-0:2018, EN IEC 60079-7:2015, EN 60079-31:2014, and EN IEC 63000:2018.

WISKA Hoppmann GmbH
Kaltenkirchen, Germany

WISKA UK Ltd
St. Columb Major, Great Britain

Signature of Head of Engineering & Design

Signature of Authorised Representative

2023-02-24

Head of Engineering & Design

Authorised Representative

